

ARKANSAS PUBLIC SERVICE COMMISSION

1st Revised Sheet No. 71.12

Replacing Original Sheet No. 71.12

Northern Arkansas Telephone Co., Inc.

Name of Company

Kind of Service: Telecommunications Class of Service: All

Part III. Rate Schedule No.: 17

Title: LIFELINE ASSISTANCE PROGRAM

MEMBER OF
SECRETARY OF COM
2017 JUL 17 A 9:58
RECEIVED
PSC File Mark Only

17. LIFELINE ASSISTANCE PROGRAM

17.4 QUALIFICATIONS

17.4.1 General

17.4.1.1 To qualify for Lifeline service, applicants must be participants in certain governmental programs or qualify through a low income threshold.

17.4.2 Qualification through Governmental Program Participation

17.4.2.1 To qualify for Lifeline service through governmental program participation, applicants must participate in at least one (1) of the following governmental programs:

1. Medicaid
2. Food Stamps
3. Supplemental Security Income (SSI)
4. Federal Public Housing Assistance Program
5. National School Lunch Program's Free Lunch Program
6. Low Income Home Energy Assistance Program

(RT)
(RT)

17.4.3 Qualification through Low Income Eligibility

17.4.3.1 To qualify through low income eligibility, the applicant's income as defined in Sec. 54.400(f) must be at or below 135% of The federal poverty guidelines.

THIS SPACE FOR PSC USE ONLY

ARKANSAS PUBLIC SERVICE COMMISSION

1st Revised Sheet No. 71.13

Replacing Original Sheet No. 71.13

Northern Arkansas Telephone Co., Inc.

Name of Company

Kind of Service: Telecommunications Class of Service: All

Part III. Rate Schedule No.: 17

Title: LIFELINE ASSISTANCE PROGRAM

ARKANSAS PUBLIC SERVICE COMMISSION

2013 OCT 24 A 8:28

RECEIVED

PSC File Mark Only

17. LIFELINE ASSISTANCE PROGRAM

17.5 CERTIFICATION

17.5.1 General

17.5.1.1 Applicants for Lifeline must meet the eligibility guidelines. A certification process shall be used to ensure only eligible applicants receive Lifeline service. Each applicant must certify that they are receiving support for only one line per household. (AT)

17.5.2 Certification of Eligibility Through Low Income Qualification

17.5.2.1 This ETC intends to participate in the ALIVE Board program established by the Arkansas General Assembly in 2005 through Act 2289 of 2005 to provide a governmentally maintained income qualification certification process that includes self-certification by applicants, under penalty of perjury, that the documentation presented by the applicant accurately represents their annual household income and provides the number of individuals in the household. Per F.C.C. order, each subscriber must provide certain certifications when enrolling in the Lifeline Program. New Lifeline subscribers must provide documentation of program-based eligibility, which the Telephone Company enrolling the subscriber should review, but not retain. Should the subscriber attempt to certify based on income, the Telephone Company shall be provided supporting documentation in order to complete the certification. The certifying document shall also include the requirement that the consumer will notify this ETC if the consumer's income exceeds 135% of the Federal Poverty Guidelines. The ALIVE Board program shall provide this ETC with a copy of the above referenced procedures. This ETC shall review the procedures to ensure the procedures are appropriate to certify and document income based eligibility for Lifeline enrollment. (CT)

THIS SPACE FOR PSC USE ONLY

ARKANSAS PUBLIC SERVICE COMMISSION

1st Revised _____ Sheet No. 71.14

Replacing Original Sheet No. 71.14

Northern Arkansas Telephone Co., Inc.
Name of Company

Kind of Service: Telecommunications Class of Service: All

Part III. Rate Schedule No.: 17

Title: LIFELINE ASSISTANCE PROGRAM

2013 OCT 24 A 8:28

RECEIVED

PSC File Mark Only

17. LIFELINE ASSISTANCE PROGRAM

(RT) (CT)

17.5.2.2 This ETC shall monitor the ALIVE Board to ensure the ALIVE Board establishes appropriate procedures and provides this ETC with a copy of such procedures. This ETC shall review the procedures to ensure the procedures are appropriate to certify and document income based eligibility for Lifeline enrollment. An officer of this ETC shall certify at time of enrollment, under penalty of perjury, to the best of the officer's knowledge, that this ETC has procedures in place to review documentation via the ALIVE Board, and that the ETC, via the ALIVE Board, was presented with documentation that confirms the consumer's household eligibility, in that the consumer's household income is at or below 135% of the Federal Poverty Guidelines.

17.5.3 Certification of Eligibility Through Participation in Governmental Programs

17.5.3.1 The applicant's eligibility for Lifeline service due to participation in governmental programs shall be certified by the applicant in coordination with the governmental entity providing, monitoring, or reviewing program participation. For instance, many programs may be provided by the Department of Human Services, Department of Health, and local school districts. This ETC, through the ALIVE Board of the third-party, will coordinate with the applicant and the appropriate governmental entity to ensure proper certification. This ETC shall require the third-party to establish appropriate procedures that include self-certification by applicants, under penalty of perjury, that the applicant receives benefits from the eligibility programs and identify the program or programs from which the applicant receives benefits. The certifying document shall also include the requirements that the consumer will notify this ETC if the consumer ceases to participate in the program or programs.

ARKANSAS PUBLIC SERVICE COMMISSION

1st Revised Sheet No. 71.15

Replacing Original Sheet No. 71.15

Northern Arkansas Telephone Co., Inc.
Name of Company

Kind of Service: Telecommunications Class of Service: All

Part III. Rate Schedule No.: 17

Title: LIFELINE ASSISTANCE PROGRAM

17. LIFELINE ASSISTANCE PROGRAM

ARK. PUBLIC SERV. COMM.

2013 OCT 24 A 8:28

RECEIVED

PSC File Mark Only

17.6 CONSUMER COMPLAINT RESOLUTION

17.6.1 General

17.6.1.1 The Federal Lifeline Program requires a consumer complaint resolution process. The Arkansas Public Service Commission has determined in Order No. 1 of Docket No. 05-038-U that any ETC, which maintains tariffs and is subject to the Public Service Commission's consumer complaint procedures, meet the dispute resolution requirements for Lifeline. This ETC is subject to the Public Service Commission's consumer complaint procedures to meet the dispute resolution requirements for Lifeline.

17.7 VERIFICATION OF CONTINUED ELIGIBILITY

17.7.1 General

17.7.1.1 The Lifeline program requires this ETC to annually monitor the continued (CT) eligibility of Lifeline participants by requiring each Lifeline subscriber, both existing subscribers and new subscribers, to provide annual self-certifications attesting to their continued eligibility of the program. Beginning in 2013, this Telephone Company will annually choose to either, where ETCs cannot re-certify their subscribers by accessing a database, to re-certify their Lifeline customers on an annual basis or elect to have USAC re-certify them. Also, should the Telephone Company choose to use a state of federal program database to confirm a consumer's on-going eligibility for Lifeline, the annual re-certification will not be implemented.

ARKANSAS PUBLIC SERVICE COMMISSION

1st Revised Sheet No. 71.16

Replacing Original Sheet No. 71.16

Northern Arkansas Telephone Co., Inc.
Name of Company

Kind of Service: Telecommunications Class of Service: All

Part III. Rate Schedule No.: 17

Title: LIFELINE ASSISTANCE PROGRAM

ARK. PUBLIC SERV. COM. FILED
2013 OCT 24 A 8:28
RECEIVED
PSC File Mark Only

17. LIFELINE ASSISTANCE PROGRAM

(RT)

17.8 PROCESS FOR TERMINATION OF LIFELINE BENEFITS

17.8.1 General

17.8.1.1 A consumer's eligibility for Lifeline may be terminated due to failure to maintain qualifications for Lifeline. This ETC shall follow the required process for termination of Lifeline benefits.

17.8.2 Process

17.8.2.1 Customers will be notified of the impending termination of Lifeline benefits in a letter separate from the consumer's monthly bill.

17.8.2.2 The customer will have up to sixty (60) days from the date of the termination letter in which to demonstrate his or her continued eligibility before Lifeline support is discontinued.

17.8.2.3 A customer who appeals must present proof of continued eligibility consistent with the above Lifeline qualifications.

17.8.2.4 This ETC will terminate Lifeline services for subscribers who fail to demonstrate continued eligibility within the sixty (60) day time period.

17.9 RECORD RETENTION POLICY

17.9.1 General

17.9.1.1 The Federal Communications Commission has established specific record retention requirements for the Lifeline certification process. This ETC will have specific procedures to ensure its record retention policy complies with legal requirements.

ARKANSAS PUBLIC SERVICE COMMISSION

1st Revised _____ Sheet No. 71.17

Replacing Original _____ Sheet No. 71.17

Northern Arkansas Telephone Co., Inc.
Name of Company _____

Kind of Service: Telecommunications _____ Class of Service: All _____

Part III. Rate Schedule No.: _____ 17 _____

Title: _____ LIFELINE ASSISTANCE PROGRAM _____

17. LIFELINE ASSISTANCE PROGRAM

ARK. PUBLIC SERV. COMM.

SECRETARY - P

2013 OCT 24 A 8:28

RECEIVED

PSC File Mark Only

17.9.1.2 This ETC, through its own recordkeeping or through the recordkeeping of the ALIVE Board and its third-party contractor on behalf of this ETC, shall maintain certification records for the period of time required by the Federal Communications Commission for all Lifeline participants.

17.9.1.3 This ETC shall retain certifications, signed by the subscriber, regarding the consumer's eligibility for Lifeline, including self-certifications, that income documentation accurately reflects the house hold income. This certification shall be retained at least as long as the consumer receives Lifeline service from this ETC or until this ETC is audited by the Administrator. This ETC shall maintain certifications for subscribers terminating Lifeline service for at least three (3) years after termination. Such records shall be maintained in compliance with all federal and Public Service Commission requirements and such records shall be provided to the Administrator or the Public Service Commission upon proper request.

THIS SPACE FOR PSC USE ONLY

ARKANSAS PUBLIC SERVICE COMMISSION

1st Revised _____ Sheet No. 71.18

Replacing Original Sheet No. 71.18

Northern Arkansas Telephone Co., Inc.
Name of Company _____

Kind of Service: Telecommunications Class of Service: All

Part III. Rate Schedule No.: _____ 17

Title: LIFELINE ASSISTANCE PROGRAM

ARK. PUBLIC SERV. COMM

FILE NO. 183-117

2013 OCT 24 A 8:29

RECEIVED

PSC File Mark Only

RESERVED FOR FUTURE USE

(RT)

THIS SPACE FOR PSC USE ONLY

ARKANSAS PUBLIC SERVICE COMMISSION 2001 JAN 20 A 8:10

RECEIVED

ORIGINAL	Sheet No. 71.19
Replacing	Sheet No.
NORTHERN ARKANSAS TELEPHONE CO., INC. Name of Company	
Kind of Service TELECOMMUNICATIONS	Class of Service All
Part III. Rate Schedule No. : 18	
TITLE: INTRACOMPANY FLAT RATED OPTIONAL PLAN	

PSC File Mark Only

(MT) 18. INTRACOMPANY PLAT RATED OPTIONAL PLAN

(MT) 18.1. GENERAL

(MT) 18.1.1. This option provides Northern Arkansas Telephone Co., Inc.'s (NATCO) customers with one-way local originating calling to all exchanges within the service area of NATCO. A customer subscribing to this service pays a flat rate for all calls within NATCO's service area to all other NATCO customers in all of NATCO's exchanges. All calls made pursuant to this IntraCompany Flat Rated Optional Plan are treated as local calls.

(MT) 18.2. RATES

(MT)		Monthly Rate	One Time Service Charge
(MT)	a. Residence/per access line	\$75.00	Standard service order charge
(MT)	b. Business/per access line	\$100.00	Standard service order charge.

Issued:

Dr. Steven G. Sanders, General Manager
 Northern Arkansas Telephone Company
 Flippin, Arkansas

Effective: Upon filing

Original _____ Sheet No. 78

Replacing _____ Sheet No. _____

Northern Arkansas Telephone Company, Inc.

Name of Company

Kind of Service: Telecommunications Class of Service: All

Part IV. Policy Schedule No.: 1

Title: RULES AND REGULATIONS

AUG 14 9 37 AM '95

FILED

PSC File Mark Only

1.18. Customer-owned Extensions

1.18.1. No Extension Charge is applied to customers using their own instrument. However, the customer must advise the Company that they are accessing the switched message network with said equipment. To the extent allowed by the Federal Communication Commission such connection shall not be used to violate the certificated rights of the telephone company as described in this Tariff.

THIS SPACE FOR PSC USE ONLY

ARKANSAS PUBLIC SERVICE COMMISSION
APPROVED

AUG 31 '95 ORDER 2 95 - 102 - TF

Original _____ Sheet No. 79

Replacing _____ Sheet No. _____

AUG 14 9 07 AM '95

Northern Arkansas Telephone Company, Inc.

Name of Company

Kind of Service: Telecommunications Class of Service: ALL

FILED

Part IV. Policy Schedule No.: 2

Title: RULES AND REGULATIONS FOR UNDERGROUND SERVICE

PSC File Mark Only

- 2. RULES AND REGULATIONS FOR UNDERGROUND SERVICE
 - 2.1. For the purposes of this rule only, the following terms have the meanings indicated for them:
 - 2.1.1. Development - Five or more adjoining unoccupied lots in a recorded plan for the construction of single-family residences (detached or otherwise) intended for year-around occupancy, or one or more adjoining lots for the construction of one or more apartment houses containing an aggregate of five or more family units, if telephone service to such residential or apartment house lots necessitates extending the company's existing distribution lines.
 - 2.1.2. Distribution Line - A main line facility within the development directly or indirectly connecting the customers in a development to the telephone central office.
 - 2.1.3. Service Line - A line from the distribution line to the customer's residence.
 - 2.1.4. Mobile Home Park - A facility designed for the parking of at least five (5) mobile homes.
 - 2.2. All distribution and service lines installed underground, shall conform to the company's construction standards and shall be owned and maintained by the company. Such installation shall be performed by the company or by such other entity as the company may authorize to do the work.
 - 2.3. The applicant for underground telephone service to a development or a lot therein shall:
 - 2.3.1. At his own cost, provide the company with easements satisfactory to the company for installation, maintenance, alteration, replacement and repair of distribution and service lines and related facilities.
 - 2.3.2. At his own cost, clear the ground, in which the aforesaid facilities are to be installed, of trees, stumps and other obstructions, provide a trench for such

THIS SPACE FOR PSC USE ONLY

ARKANSAS PUBLIC SERVICE COMMISSION
APPROVED

AUG 31 '95 ORDER 2 95 - 102 - TF

Original _____ Sheet No. 80

Replacing _____ Sheet No. _____

Northern Arkansas Telephone Company, Inc.
Name of Company

Kind of Service: Telecommunications Class of Service: ALL

Part IV. Policy Schedule No.: 2

Title: RULES AND REGULATIONS FOR UNDERGROUND SERVICE

AUG 14 9 37 AM '95

FILED

PSC File Mark Only

facilities according to telephone company specifications and backfill to rough grade. It is understood that the telephone facilities may be installed in the same trench as facilities to be installed for the purpose of providing electric service to the development, if installed in accordance with the National Electric Safety Code as from time to time amended, unless, in the judgment of the company such joint installation would be dangerous or impractical because of lack of cooperation with the power company or other reasons beyond the control of the company.

- 2.3.3. Request installation of the facilities at such time that the aforesaid facilities may be installed before curbs, pavements and sidewalks are installed; keep the trenches in which the facilities are to be installed, or the path to be utilized for installation of underground facilities by "plowing in" (as distinguished from "trenching"), clear of machinery and other obstructions during the installation and will otherwise cooperate with the company to avoid unnecessary costs.
- 2.3.4. Deposit with the company, prior to the commencement of the installation of the facilities referred to above, an amount equal to the company's estimated costs of installing the facilities within the development. Such deposit is conditioned upon the agreement of the company to refund; semi-annually, to the applicant for each customer located within the development, receiving telephone service from the company within the period of five (5) years from the date of installation of facilities that percentage of the total deposit that each lot bears to the total number of lots in the development. All sums not refunded within the five (5) year period shall become the property of the company.
- 2.3.5. If after the acceptance of application for service the design of the development is changed in a manner which required recomputation of the company's estimated installation costs, or the estimated cost of installation are increased for any other reason not the fault of the company, the deposit referred to above may be increased and the company may defer or discontinue installation of facilities until such time as the additional amount of the deposit has been received by the company.

THIS SPACE FOR PSC USE ONLY

ARKANSAS PUBLIC SERVICE COMMISSION
APPROVED

AUG 31 '95 ORDER 2 95 - 102 - TF

ARKANSAS PUBLIC SERVICE COMMISSION

ARK. PUBLIC SERV. COMM.
JAN SANDERS
SECRETARY OF COMM.

Original _____ Sheet No. 81

Replacing _____ Sheet No. _____

AUG 14 9 37 AM '95

Northern Arkansas Telephone Company, Inc.
Name of Company

FILED

Kind of Service: Telecommunications Class of Service: All

Part IV. Policy Schedule No.: 2

Title: RULES AND REGULATIONS FOR UNDERGROUND SERVICE

PSC File Mark Only

- 2.3.6. Reimburse the company for damage to, or destruction or removal of, underground facilities within the development, during the period of development, by persons, firms or corporations other than the company or its' agents, employees or contractors.
- 2.4. The above provisions shall apply to underground service for mobile home parks.
- 2.5. At the expense of the applicant, underground service will be provided on a temporary basis during the construction of residential or commercial properties. If all or part of the facilities are utilized in providing service to the residence or commercial property, an adjustment of cost will be made.
- 2.6. If a customer or customers request the removal and replacement of existing overhead facilities with underground facilities, such replacement will be done at the expense of the customer or customers.
- 2.7. Underground service connections to new individual residences, new mobile homes and new apartments containing less than five (5) family units, from existing overhead facilities will be provided at the request of the customer, if the customer pays to the company a sum equal to the difference between the estimated cost of the overhead facilities and the estimated cost of underground facilities, and provides to the company easements adequate for the installation, maintenance, alteration, replacement or repair of distribution and service lines and related facilities.
- 2.8. Underground service to shopping centers and other commercial developments will be provided on the same basis as underground service to residential developments as hereinabove set out.

THIS SPACE FOR PSC USE ONLY

ARKANSAS PUBLIC SERVICE COMMISSION
APPROVED

AUG 31 '95 ORDER 2 95 - 102 - TF

ARKANSAS PUBLIC SERVICE COMMISSION

ARK. PUBLIC SERV. COMM.
JAN SANDERS
SECRETARY OF COMM.

Original _____ Sheet No. 82

Replacing _____ Sheet No. _____

Northern Arkansas Telephone Company, Inc.
Name of Company

Kind of Service: Telecommunications Class of Service: All

Part IV. Policy Schedule No.: 2

Title: RULES AND REGULATIONS FOR UNDERGROUND SERVICE

AUG 14 9 37 AM '95

FILED

PSC File Mark Only

2.9. These rules and regulations shall not amend or supercede the company's line extension policy set out in other tariffs on file with the Arkansas Public Service Commission.

THIS SPACE FOR PSC USE ONLY

ARKANSAS PUBLIC SERVICE COMMISSION
APPROVED

AUG 31 '95 ORDER 2 95 - 102 - TF

ARKANSAS PUBLIC SERVICE COMMISSION

ARK. PUBLIC SERV. COMM.
JAN 24 1995
SECRETARY OF COMM.

Original _____ Sheet No. 83

Replacing _____ Sheet No. _____

Northern Arkansas Telephone Company, Inc.
Name of Company

Kind of Service: Telecommunications Class of Service: All

Part IV. Policy Schedule No.: 3

Title: EXTENDED ABSENCE PAYMENT PLAN

AUG 14 9 37 AM '95

FILED

PSC File Mark Only

3. EXTENDED ABSENCE PAYMENT PLAN

3.1. The following options are available to customers to avoid suspension of service during extended absences.

3.1.1. Bills coming due during the customer's absence may be paid in advance. The amount of the advance payment will be based on the customer's average monthly bill for the most recent 12 months. If less than 12 months usage history is available, the advance payment will be based on the number of months of usage history available. If the advance payment is more than the actual bill for service, the overpayment will be credited to the customer's account unless the customer requests a refund. If the advance payment is less than the actual bill for service, the balance due will be carried forward each month until the customer returns. Delayed payment agreements will be available for any underpayment.

3.1.2. The customer will be given the opportunity to enroll in the Company's Bank Draw Draft Plan whereby the monthly service bill will be paid automatically through the customer's checking or savings account.

3.1.3. The customer can arrange to have bills coming due during the period of the absence mailed to an alternate address or third party during the absence.

3.2. The customer must notify the Company in order to take advantage of any of these extended absence payment plans.

THIS SPACE FOR PSC USE ONLY

ARKANSAS PUBLIC SERVICE COMMISSION
APPROVED

AUG 31 '95 ORDER 2 95 - 102 - TF

Original Sheet No. 84

Replacing _____ Sheet No. ____

Northern Arkansas Telephone Company, Inc.

Name of Company

Kind of Service: Telecommunications Class of Service: All

Part IV. Policy Schedule No.: 4

Title: EXTENDED DUE DATE PLAN

AUG 14 9 37 AM '95

FILED

PSC File Mark Only

4. EXTENDED DUE DATE PLAN

4.1. GENERAL

4.1.1. The Extended Due Date Plan is available to qualifying residential customers and is intended to enable the company to change a customer's bill payment due date, at the customer's request, to coincide with or follow the customer's receipt of a fixed income as listed below. Customers who qualify under this plan and pay by the new date will not be considered late on their bill payment.

4.2. AVAILABILITY

4.2.1. Customers whose income checks from any of the sources listed below are not normally received by the regular bill due date are eligible to apply for an extended due date. Qualifying income sources are as follows:

- A. persons receiving Aid to Families with Dependent Children (AFDC), or Aid to the Aged, Blind and Disabled (AABD);
- B. persons receiving Supplemental Security Income; or,
- C. persons whose primary source of income is Social Security or Veterans Administration disability or retirement benefits.

4.3. APPLICATION

4.3.1. Customers shall become plan participants upon either written or verbal application to the Company. Participation will continue each month thereafter, regardless of account location, as long as the customer's account remains active. Verification of income being received by the customer may be required.

THIS SPACE FOR PSC USE ONLY

ARKANSAS PUBLIC SERVICE COMMISSION
 APPROVED

AUG 31 '95 ORDER 2 95 - 102 - TF

Original Sheet No. 85

Replacing _____ Sheet No. ____

Northern Arkansas Telephone Company, Inc.

Name of Company

Kind of Service: Telecommunications Class of Service: All

Part IV. Policy Schedule No.: 4

Title: EXTENDED DUE DATE PLAN

AUG 14 9 37 AM '95

FILED

PSC File Mark Only

4.4. SETTING THE EXTENDED DUE DATE

4.4.1. During the billing procedure each month, the Company billing system will compare the check receipt date supplied by the customer with the billing date and the bill due date. Based on this comparison, the following method of determining a bill due date will be used:

- A. If the check receipt date occurs within the time span between the billing date and the bill due date, the normal bill due date of the account remains in effect.
- B. If the check receipt date occurs beyond the time span of the billing date and the bill due date, the due date will be at least three days after the check receipt date and only the extended due date will appear on the customer's bill.

4.4.2. If the customer does not pay bills by the close of business on the extended due date 2 times in a row or any 3 times in the last 12 months, the Company will remove the customer from the plan. The Company will notify the customer in writing when the customer has been removed from the plan for late payment.

4.4.3. The Company will not impose a late payment charge on plan participants who do not pay by the extended due date.

4.4.4. If payments are not received by the close of business on the extended due date, the Company will follow the established notification process established by the Arkansas Public Service Commission which could ultimately result in suspension of service.

THIS SPACE FOR PSC USE ONLY

ARKANSAS PUBLIC SERVICE COMMISSION
APPROVED

AUG 31 '95 ORDER 2 95 - 102 - TF

ARKANSAS PUBLIC SERVICE COMMISSION

5th Revised Sheet No. 86

Replacing 4th Revised Sheet No. 86

Northern Arkansas Telephone Co., Inc.

Name of Company

Kind of Service: Telecommunications Class of Service: All

Part III. Rate Schedule No.: 5

Title: RESERVED FOR FUTURE USE

ARK. PUBLIC SERV. COMM

SECRETARY OF COMM.

2014 SEP -2 A 9: 33

RECEIVED

PSC File Mark Only

5. **RESERVED FOR FUTURE USE**

(RT)(DR)

THIS SPACE FOR PSC USE ONLY

ARKANSAS PUBLIC SERVICE COMMISSION

ARRESTED BY DOHM.
SERIAL NO. F000M.

1st Revised Sheet No. 87

Replacing Original Sheet No. 87

FEB 13 10 54 AM '97

Northern Arkansas Telephone Company, Inc.

Name of Company

Telecommunications All
Kind of Service: _____ Class of Service: _____

FILED

Part IV. Policy Schedule No.: 6

Title: RESERVED FOR FUTURE USE

PSC File Mark Only

6. RESERVED FOR FUTURE USE

(CT)

(RT)

THIS SPACE FOR PSC USE ONLY

ARKANSAS PUBLIC SERVICE COMMISSION
APPROVED

MAR 4 '97 ORDER. 1 97-045-TF

ARKANSAS PUBLIC SERVICE COMMISSION

AR. P. S. C. COMM.
OFFICE OF THE
SECRETARY OF COMM.

Original Sheet No. 88

Replacing _____ Sheet No. ____

Northern Arkansas Telephone Co., Inc.

Name of Company

Telecommunications
Kind of Service: _____ Class of Service: All

Part IV. Policy Schedule No.: 7

Title: OBLIGATIONS OF THE COMPANY

PSC File Mark Only

AUG 25 9 20 AM '95

FILED

7. OBLIGATIONS OF THE COMPANY

7.1. Furnishing of Service

The Company's obligation to furnish service is dependent upon its ability to secure and retain, without unreasonable expense, suitable facilities and rights for the construction and maintenance of the necessary circuits and equipment, up to and including the point of demarcation.

7.2. Maintenance and Repairs

7.2.1. All facilities owned by the Company up to and including the point of demarcation, will be maintained by it, except where such facilities are situated, in the judgement of the Company, in hazardous or inaccessible locations.

7.2.2. The Company will be reimbursed for any loss or damage to its facilities on the customer's premises resulting from intentional destruction or any other cause, except from fire or unavoidable accidents.

7.2.3. The customer shall provide employees and agents of the Company access to Company facilities at all reasonable times.

7.2.4. If the problem is on the customer's side of the demarcation point, the customer shall be notified.

A. The Company will inform the customer that if the Company is requested to diagnose and repair the problem, charges incurred are not regulated by the Arkansas Public Service Commission, or that the customer shall assume full responsibility for having the problem diagnosed and repaired.

THIS SPACE FOR PSC USE ONLY

ARKANSAS PUBLIC SERVICE COMMISSION
APPROVED

AUG 31 '95 ORDER 2 95 - 102 - TF

ARKANSAS PUBLIC SERVICE COMMISSION

ARK. PUBLIC SERVICE COMMISSION
SECRETARY'S OFFICE

Original Sheet No. 89

Replacing _____ Sheet No. ____

AUG 25 9 29 AM '95

Northern Arkansas Telephone Co., Inc.

Name of Company

Telecommunications

Kind of Service: _____ Class of Service: All

Part IV. Policy Schedule No.: 7

Title: OBLIGATIONS OF THE COMPANY

PSC File Mark Only

B. Repairs to the customer premises equipment or inside wire may also be performed as specified under a Company provided maintenance agreement, if one exists with the customer. Inside wire is that telephone plant, including materials and labor, but excluding station equipment, installed on the customer's side of the demarcation point.

7.2.5. There will be no trip charge made to the customer for isolating the trouble at the demarcation point.

THIS SPACE FOR PSC USE ONLY

ARKANSAS PUBLIC SERVICE COMMISSION
APPROVED

AUG 31 '95 ORDER 2 95-102-TF

ARKANSAS PUBLIC SERVICE COMMISSION

ARK. PUBLIC SERV. COMM.
JAN SANDERS
SECRETARY OF COMM.

Original Sheet No. 90

Replacing _____ Sheet No. _____

AUG 14 9 37 AM '95

Northern Arkansas Telephone Company, Inc.

Name of Company

FILED

Kind of Service: Telecommunications Class of Service: All

Part V. Map Schedule No.: 1

Title: BULL SHOALS EXCHANGE

PSC File Mark Only

Beginning at a point where the center line of the Fairview branch of the Jimmie Creek arm of Bull Shoals Lake intersects with the South (S) section line of Section 25, near the Southeast (SE) corner of Section 25, T 20 N, R 16 W; thence East (E) approximately 180 feet to the Southeast (SE) corner of Section 25; thence East approximately 2 miles to the Southeast (SE) corner of Section 29, T 20 N, R 15 W; thence North (N) approximately 1/10 of a mile to a point where the East (E) line of Section 29 intersects with the center line of the White River, being the Marion/Baxter County Line; thence meandering along the center line (County line) of said river in a Northwesterly then Northeasterly direction to the Bull Shoals Dam; thence continuing along the center line of the main channel of Bull Shoals Lake in a Northeasterly (NE), then a Westerly (W) direction to point where the center line of the main channel of Bull Shoals Lake intersects with the center line of the Jimmie Creek arm of said lake in the Northwest (NW) corner of Section 8, T 20 N, R 15 W; thence meandering in a Southwesterly direction along the center line of the Jimmie Creek arm of Bull Shoals Lake to a point where the center line of the Fairview branch of Bull Shoals Lake intersects with the center line of the Jimmie Creek arm of Bull Shoals Lake in the West Half of Section 25, T 20 N, R 16 W; thence meandering along the center line of the Fairview branch in a Southeasterly direction to

THIS SPACE FOR PSC USE ONLY

ARKANSAS PUBLIC SERVICE COMMISSION
APPROVED

AUG 31 '95 ORDER 2 95-102-TF

ARKANSAS PUBLIC SERVICE COMMISSION

ARK. PUBLIC. SERV. COMM.
JAN SANDERS
SECRETARY OF COMM.

Original Sheet No. 91

Replacing _____ Sheet No. ____

AUG 14 9 38 AM '95

Northern Arkansas Telephone Company, Inc.

Name of Company

FILED

Kind of Service: Telecommunications Class of Service: All

Part V. Map Schedule No.: 1

Title: BULL SHOALS EXCHANGE

PSC File Mark Only

a point where the said center line intersects with the South (S) section line of Section 25, near the Southeast corner of Section 25, T 20 N, R 16 W; the point of beginning:

THIS SPACE FOR PSC USE ONLY

ARKANSAS PUBLIC SERVICE COMMISSION
APPROVED

AUG 31 '95 ORDER 2 95 - 102 - TF

ARKANSAS PUBLIC SERVICE COMMISSION

JAN SANDERS
SECRETARY OF COMM.

ARK. PUBLIC SERV. COM.
JAN SANDERS
SECRETARY OF COMM.

Original Sheet No. 93

Replacing _____ Sheet No. _____

AUG 14 9 38 AM '95

AUG 14 9 38 AM '95

Northern Arkansas Telephone Company, Inc.

FILED

FILED

Name of Company

Kind of Service: Telecommunications Class of Service: All

Part V. Map Schedule No.: 3

Title: DIAMOND CITY EXCHANGE

PSC File Mark Only

Beginning at a point where the center line of Bull Shoals Lake intersects with the center line of the outlet of the West Sugerloaf Creek in the Southwest Quarter (SW 1/4) of Section 8, T 21 N, R 18 W; thence meandering along the center line of said lake in a Southeasterly (SE) direction to a point where the said center line intersects with the center line of the outlet of the East Sugerloaf Creek in the Northwest Quarter (NW1/4) of Section 16; thence meandering along the center line of said creek in a Southeasterly (SE) direction to a point where the center line intersects with the East (E) line of Section 28, this being the Boone-Marion county line; thence South (S) along the County line to the Southeast (SE) corner of the Northeast Quarter (NE 1/4) of the Northeast Quarter (NE 1/4) of Section 33; thence West (W) to the Southwest (SW) corner of the Northwest Quarter (NW 1/4) of the Northwest Quarter (NW 1/4) of Section 33; thence North (N) to the Northeast (NE) corner of the Southeast Quarter (SE 1/4) of the Southeast Quarter (SE 1/4) of Section 29; thence West (W) to a point where the North (N) line of the South Half (S 1/2) of the Southwest Quarter (SW 1/4) of Section 30 intersects with the center line of the West Sugerloaf Creek; thence meandering in a Northeasterly (NE) direction to the center line of Bull Shoals Lake; The point of beginning:

THIS SPACE FOR PSC USE ONLY

ARKANSAS PUBLIC SERVICE COMMISSION
APPROVED

AUG 31 '95 ORDER 2 95-102-TF

Northern Arkansas Telephone Co., Inc.

Kind of Service: Telecommunications Class of Service: All

Part V. Map Scheule No.: 4

Title: DIAMOND CITY MAP

ARKANSAS PUBLIC SERVICE COMMISSION
APPROVED
AUG 31 '95 ORDER 211 95-102-TF

M I S S O U R I

R 19 W

R 18 W

TANEY

COUNTY

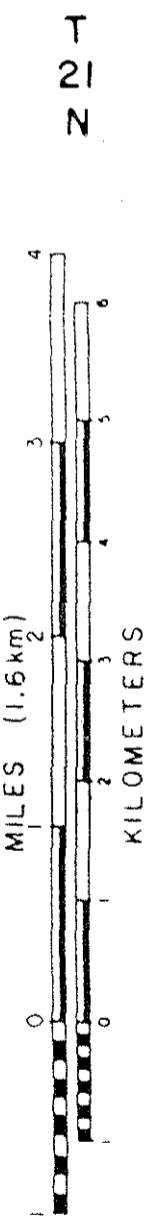
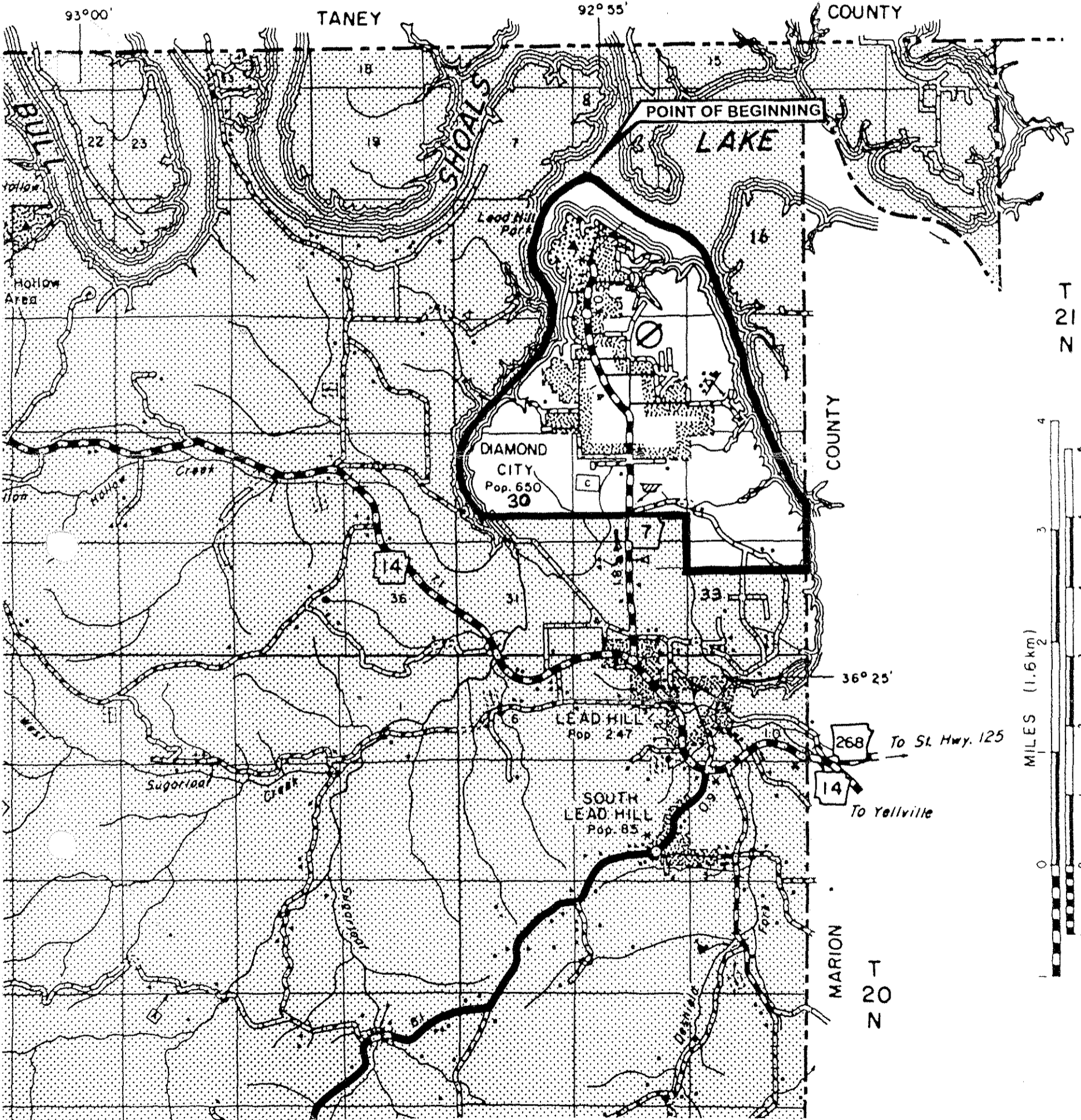

FILED

AUG 14 9 38 AM '95

ARKANSAS PUBLIC SERVICE COMMISSION

ARK. PUBLIC SERV. COMM.
JAN SANDERS
SECRETARY OF COMM.

Original

Sheet No. 95

Replacing _____ Sheet No. _____

NORTHERN ARKANSAS TELEPHONE COMPANY, INC

AUG 14 9 38 AM '95

FILED

Name of Company

Telecommunications All

Kind of Service: _____ Class of Service: _____

Part V. Map Schedule No.: 5

FLIPPIN EXCHANGE

Title:

PSC File Mark Only

Beginning at a point where the center line of the Jimmie Creek arm of Bull Shoals Lake intersects with the center line of the Fairview branch of Bull Shoals Lake in the North Half (N 1/2) of the Southwest Quarter (SW 1/4) of Section 25, T 20 N, R 16 W; thence meandering along the center line of the Fairview branch in a southeasterly direction to a point where the said center line intersects with the South (S) section line of Section 25, near the Southeast (SE) corner of Section 25; thence east to the Southeast (SE) corner of Section 25; thence east approximately 2 miles to the Southeast (SE) corner of Section 29, T 20 N, R 15 W; thence North (N) approximately 1/10 of a mile to a point where the East line of Section 29 intersects with the center line of the White River, being the Marion/Baxter county line; thence meandering along the said center line of the White River in a generally Southeasterly direction for approximately 22 miles to a point where the center line intersects with the center line of the Buffalo River in Section 26, T 18 N, R 14 W; thence Southeasterly along the center line of Buffalo River to a point where the said center line intersects with the East (E) Section line of Section 35, near the Northeast (NE) corner; thence south approximately 8/10 of a mile to a point where the East line of Section 35 intersects with center line of Buffalo River near the Southeast corner of Section 35; thence Southwest along the center line of the river to a point where the said center line intersects with the South (S) Section line of Section 35; thence West (W) approximately 9/10 of a mile to the Northeast (NE) corner

THIS SPACE FOR PSC USE ONLY

ARKANSAS PUBLIC SERVICE COMMISSION
APPROVED

AUG 31 '95 ORDER 2000 95-102-TF

ARKANSAS PUBLIC SERVICE COMMISSION

ARK. PUBLIC SERV. COMM.
JAN SANDERS
SECRETARY OF COMM.

Original _____ Sheet No. 96

Replacing _____ Sheet No. _____

NORTHERN ARKANSAS TELEPHONE COMPANY, INC.

Name of Company _____

Kind of Service: Telecommunications Class of Service: All

Part V. Map Schedule No.: 5

Title: FLIPPIN EXCHANGE

AUG 14 9 38 AM '95

FILED

PSC File Mark Only

of Section 3, T 17 N, R 14 W; thence South (S) approximately 2 miles to the Southeast corner of Section 10; thence east approximately 1 mile to the Southwest corner of Section 12; thence North (N) approximately 1 mile to the Northwest (NW) corner of Section 12; thence East (E) approximately one mile (along the Baxter/Marion county line) to the Northeast (NE) corner of Section 12; thence South (S) approximately 5 miles along the Baxter/Marion county line to the Southeast (SE) corner of Section 36; thence west along the Marion/Searcy county line approximately 6 miles to the Southwest (SW) corner of Section 31; thence North approximately 6 miles to the Northwest (NW) corner of Section 6; thence west (W) approximately 2 miles to the Southwest (SW) corner of Section 35, T 18 N, R 15 W; thence North (N) approximately 2 1/2 miles to the Northeast (NE) corner of the Southeast (SE) 1/4 of Section 22; thence West (W) approximately 1 mile to the Northwest (NW) corner of the Southwest (SW) 1/4 of Section 22; thence South (S) approximately 1/2 mile to the Southeast (SE) corner of Section 21; thence West (W) approximately 1 mile to the Southwest (SW) corner of Section 21; thence South (S) approximately 1 mile to the Southeast (SE) corner of Section 29; thence West (W) approximately 1 mile to the Southwest (SW) corner of Section 29; thence North (N) approximately 1 mile to the Northwest (NW) corner of Section 29; thence West (W) approximately 1 mile to the Southwest (SW) corner of Section 19; thence North (N) approximately 3 miles to the Northwest (NW) corner of Section 7; thence East (E) approximately 1 mile to the

THIS SPACE FOR PSC USE ONLY

ARKANSAS PUBLIC SERVICE COMMISSION
APPROVED

AUG 31 '95 ORDER 2 95-102-TF

ARKANSAS PUBLIC SERVICE COMMISSION

ARK. PUBLIC. SERV. COMM.
JAN SANDERS
SECRETARY OF COMM.

Original _____

Sheet No. 97

Replacing _____

Sheet No. _____

AUG 14 9 38 AM '95

NORTHERN ARKANSAS TELEPHONE COMPANY, INC.

Name of Company _____

Kind of Service: Telecommunications Class of Service: All

FILED

Part V. Map Schedule No.: 5

FLIPPIN EXCHANGE

Title: _____

PSC File Mark Only

Northeast (NE) corner of Section 7; thence North (N) approximately 1 mile to the Northwest (NW) corner of Section 5; thence West (W) approximately 1 mile to the Southwest (SW) corner of Section 31, T 19 N, R 15 W; thence North (N) to the Northwest (NW) corner of Section 31; thence West (W) approximately 1 1/2 miles to the Southwest (SW) corner of the Southeast Quarter (SE 1/4) of Section 26, T 19 N, R 16 W; thence North (N) approximately 2 miles to the Northwest (NW) corner of the Northeast Quarter (NE 1/4) of Section 23; thence west (W) approximately 1/2 mile to the Southwest (SW) corner of Section 14; thence North (N) approximately 1 1/4 mile to a point where the West (W) Section line of Section 11 intersects with the center line of Moccasin Creek; thence meandering along the said center line of Moccasin Creek in a Northwesterly, then Northeasterly direction for approximately 2 1/2 miles to a point where the center line of said creek intersects with the center line of the Jimmie Creek arm of Bull Shoals Lake in the Southeast Quarter (SE 1/4) of Section 34, T 20 N, R 16 W; thence following the center line of the Jimmie Creek arm of Bull Shoals Lake in a Northeasterly (NE) direction for approximately 1 3/4 miles to a point where the said center line intersects with the center line of the Fairview branch of Bull Shoals Lake in the North Half (N 1/2) of the Southwest Quarter (SW 1/4) of Section 25, T 20 N, R 16 W; The point of beginning:

THIS SPACE FOR PSC USE ONLY

ARKANSAS PUBLIC SERVICE COMMISSION
APPROVED

AUG 31 '95 ORDER 2 95 - 102 - TF

Original Sheet No. 98

Northern Arkansas Telephone Co., Inc.

Kind of Service: Telecommunications Class of Service: All

Part V. Map Schedule No.: 6

Title: FLIPPIN MAP

ARKANSAS PUBLIC SERVICE COMMISSION
APPROVED

AUG 31 '95 ORDER 244-95-102-TF

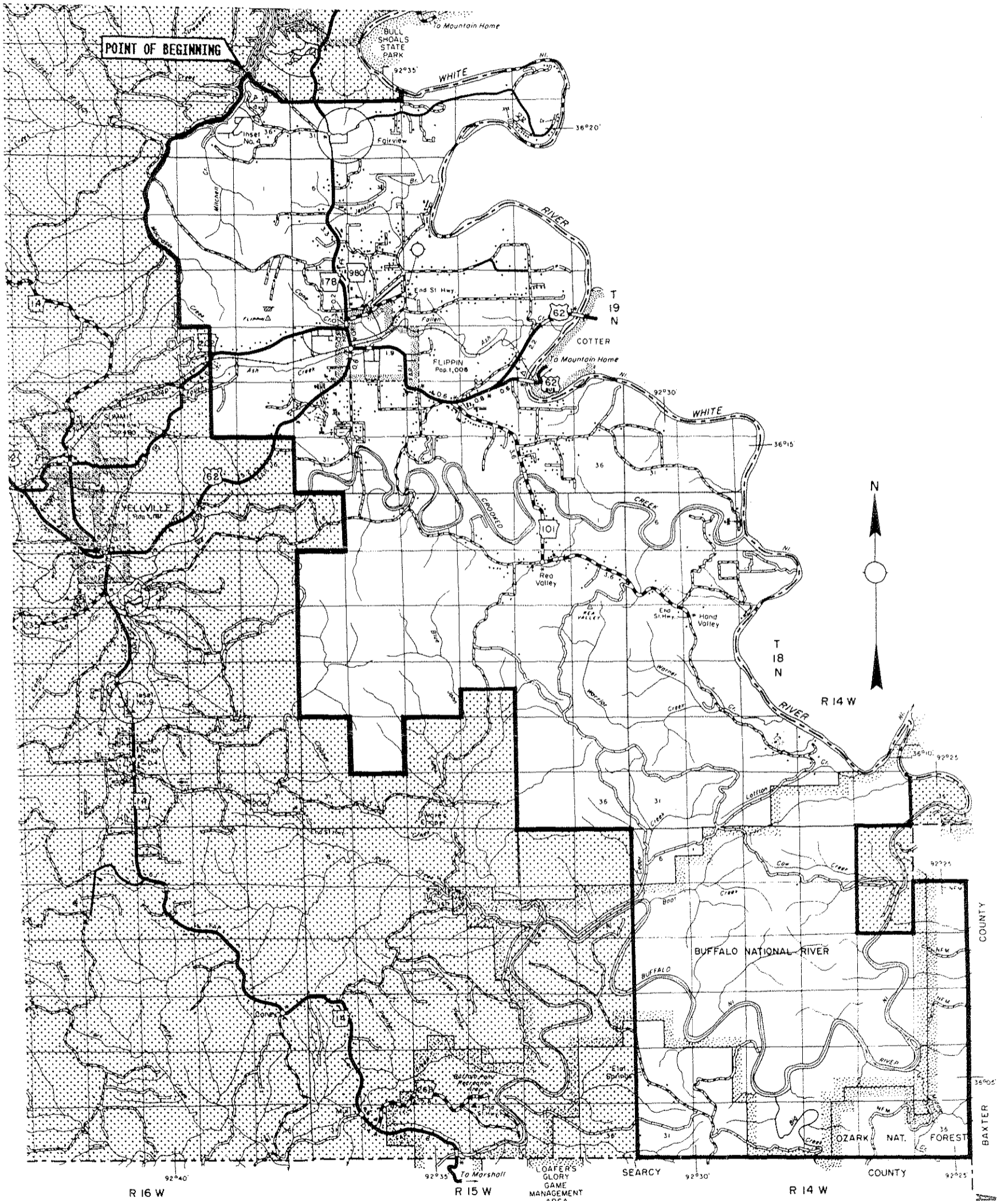

FILED

AUG 14 9 38 AM '95

SECRETARY OF COMM.

Northern Arkansas Telephone Co., Inc.

Kind of Service: Telecommunications Class of Service: All

Part V. Map Schedule No.: 7

Title: FLIPPIN BRA MAP

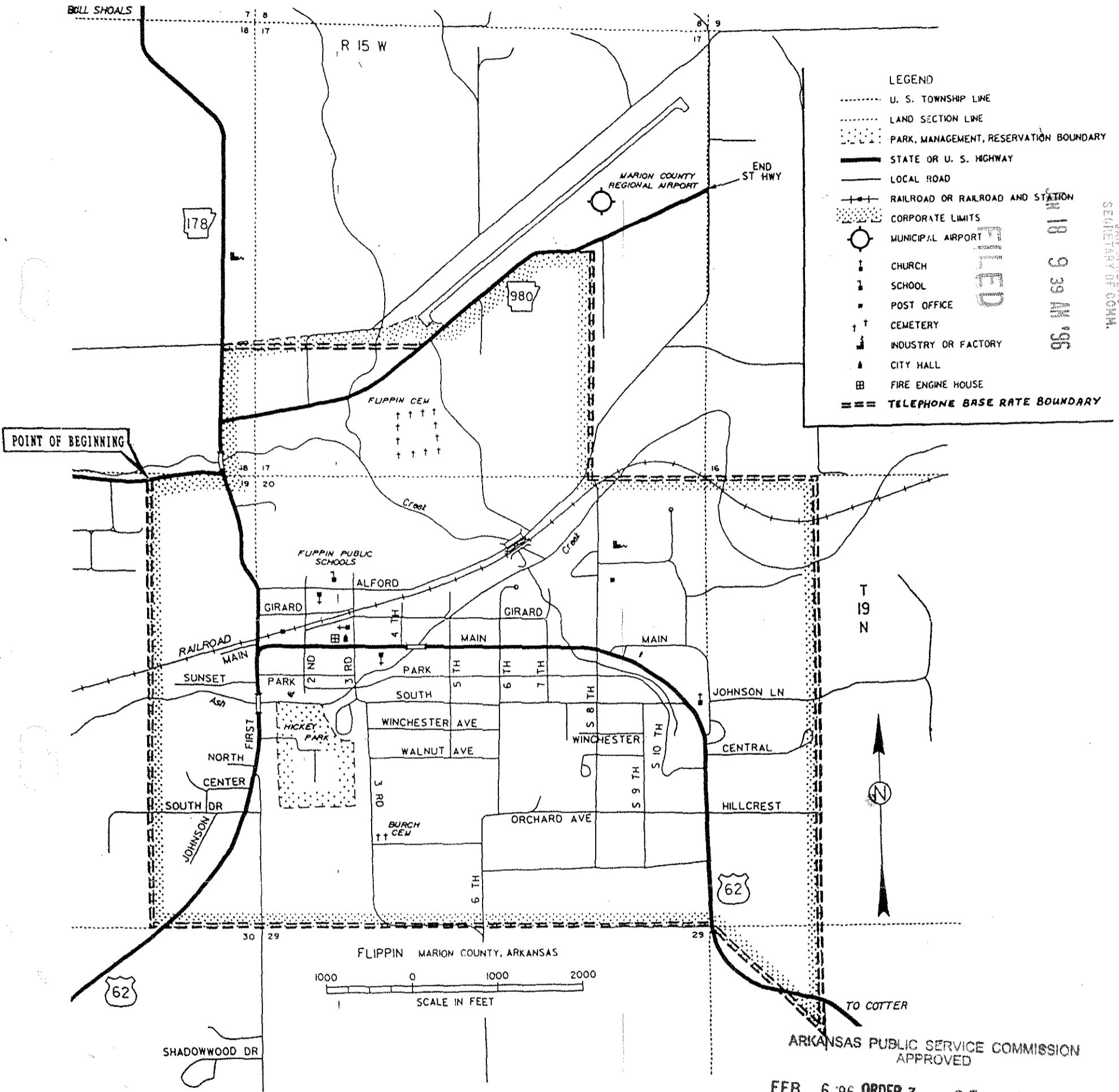

ARKANSAS PUBLIC SERVICE COMMISSION
 APPROVED
 FEB 6 '96 ORDER 3 95-102-TF

ARKANSAS PUBLIC SERVICE COMMISSION
 JAMES W. STUBBS
 SECRETARY OF COMMISSION

ARKANSAS PUBLIC SERVICE COMMISSION

ARK. PUBLIC SERV. COMM.
JAN SANDERS
SECRETARY OF COMM.

Original Sheet No. 100

Replacing _____ Sheet No. _____

Northern Arkansas Telephone Company, Inc.

Name of Company

Kind of Service: Telecommunications Class of Service: All

Part V. Map Schedule No.: 8

Title: LEAD HILL EXCHANGE

AUG 14 9 38 AM '95

FILED

PSC File Mark Only

Beginning at a point where the center line of the Bear Creek Arm of Bull Shoals Lake intersects with the center line of Bull Shoals Lake and the Arkansas-Missouri State Line in Section 5, T 21 N, R 19 W; thence meandering along said center line of said lake in a southeasterly then northwesterly direction to a point where the said center line intersects with the Arkansas-Missouri State Line in the Northeast (NE) corner of Section 14, T 21 N, R 18 W; thence East along said State Line approximately 1 1/4 miles to a point where the said State Line intersects with the center line of Bull Shoals Lake in Section 2, T 21 N, R 19 W; thence meandering along the center line of said lake in a southerly, then northeasterly, then southerly direction for approximately 5 1/2 miles to a point where it intersects with the center line of the outlet of the West Sugarloaf Creek in the Southwest Quarter (SW 1/4) of Section 8, T 21 N, R 18 W; thence meandering in a southwesterly direction along said creek to a point where it intersects with the North Line of the South Half (S 1/2) of the Southwest Quarter (SW 1/4) of Section 30; thence east to the Northeast (NE) corner of the Southeast Quarter (SE 1/4) of the Southeast Quarter (SE 1/4) of Section 29; thence south to the Southwest (SW) corner of the Northwest Quarter (NW 1/4) of the Northwest Quarter (NW 1/4) of Section 33; thence east to the East Line of Section 33, T 21 N, R 18 W, this being the Boone-Marion County Line; thence north approximately 1/2 mile to the Northeast corner of the Southeast Quarter (SE 1/4) of the Southeast Quarter (SE 1/4) of Section 28, T 21 N, R

THIS SPACE FOR PSC USE ONLY

ARKANSAS PUBLIC SERVICE COMMISSION
APPROVED

AUG 31 '95 ORDER 2 95 - 102 - TF

ARKANSAS PUBLIC SERVICE COMMISSION

ARK. PUBLIC SERV. COMM.
JAN SANDERS
SECRETARY OF COMM.

Original Sheet No. 101

AUG 14 9 38 AM '95

Replacing _____ Sheet No. ____

Northern Arkansas Telephone Company, Inc.

FILED

Name of Company

Kind of Service: Telecommunications Class of Service: All

Part V. Map Schedule No.: 8

Title: LEAD HILL EXCHANGE

PSC File Mark Only

18 W, a point near the center line of the East Sugarloaf Arm of Bull Shoals Lake; thence meandering along said center line in an northwesterly direction for approximately 3 miles to a point where said center line intersects with the main channel of Bull Shoals Lake in the Northwest Quarter (NW 1/4) of Section 16, T 21 N, R 18 W; thence meandering along said center line of the main channel of Bull Shoals Lake in a northeasterly direction to a point where the center line of said lake intersects the Boone-Marion County Line; thence meandering in a southeasterly then northeasterly direction for approximately 9 miles to a point where the center line of Bull Shoals Lake intersects the Arkansas-Missouri State Line, near the Northeast (NE) corner of Section 15, T 21 N, R 17 W; thence east approximately 1 1/4 miles to a point where the State Line intersects with the center line of Bull Shoals Lake; thence meandering in a southeasterly direction along said center line of said lake to a point where the center line of the main channel intersects with the center line of the Big Creek Arm of Bull Shoals Lake in Section 31, T 21 N, R 16 W; thence meandering along the center line of the Big Creek Arm in a Northeasterly direction to a point where the center line of Big Creek intersects with the center line of the Cedar Creek Arm of Bull Shoals Lake in the Southeast 1/4 (SE 1/4) of Section 19, T 21 N, R 16 W; thence meandering in a northeasterly direction along the center line of the Cedar Creek Arm of Bull Shoals Lake to a point where said center line intersects with the Arkansas-Missouri State Line in the

THIS SPACE FOR PSC USE ONLY

ARKANSAS PUBLIC SERVICE COMMISSION
APPROVED

AUG 31 '95 ORDER 2 95-102-TF

ARKANSAS PUBLIC SERVICE COMMISSION

ARK. PUBLIC SERV. COMM.
JAN SANDERS
SECRETARY OF COMM.

Original Sheet No. 102

Replacing _____ Sheet No. ____

Northern Arkansas Telephone Company, Inc.

Name of Company

Kind of Service: Telecommunications Class of Service: All

Part V. Map Schedule No.: 8

Title: LEAD HILL EXCHANGE

AUG 14 9 38 AM '95

FILED

PSC File Mark Only

Northwest Quarter (NW 1/4) of Section 15, T 21 N, R 16 W; thence east approximately 3 1/3 miles along Arkansas-Missouri State line to a point where the State line intersects with the center line of the Little North Fork Arm of Bull Shoals Lake along the North Section Line of Section 18, T 21 N, R 15 W; thence meandering along the center line of the Little North Fork Arm of Bull Shoals Lake in a southerly direction to a point where the said center line intersects with the center line of the main channel of Bull Shoals Lake in the Southeast Quarter (SE 1/4) of Section 25, T 21 N, R 16 W; thence meandering along the center line of the main channel of Bull Shoals Lake in a southwesterly then southeasterly direction to a point where the center line intersects with the center line of the Jimmy Creek Arm of Bull Shoals Lake in the North 1/2 (N 1/2) of Section 8, T 20 N, R 15 W; thence meandering along the center line of the Jimmy Creek Arm of Bull Shoals Lake in a southwesterly direction to a point where the center line intersects with the center line of Brushy Fork Creek in the Southeast Quarter (SE 1/4), of Section 34, T 20 N, R 16 W; thence meandering along the center line of Brushy Fork in a westerly, then southwesterly, then southeasterly direction for approximately 3 3/4 miles to a point where the center line of Brushy Fork Creek intersects with the West (W) line of the Southwest Quarter (SW 1/4) of Southeast Quarter (SE 1/4) of Section 6, T 19 N, R 16 W; Thence south along said quarter section line to a point where the center line of Brushy Fork Creek intersects with the said quarter section line, near the Southwast (SW)

THIS SPACE FOR PSC USE ONLY

ARKANSAS PUBLIC SERVICE COMMISSION
APPROVED

AUG 31 '95 ORDER 2 95 - 102 - TF

ARKANSAS PUBLIC SERVICE COMMISSION

ARRESTED BY THE
SECURITY OF COMM.

Original Sheet No. 103

Replacing Sheet No. _____

AUG 25 9 29 AM '95

Northern Arkansas Telephone Co., Inc.

Name of Company

Telecommunications All

Kind of Service: _____ Class of Service: _____

Part V. Map Schedule No.: 8

Title: LEAD HILL EXCHANGE

PSC File Mark Only

corner of the Southeast Quarter (SE 1/4) of Section 6; Thence meandering along the center line of Brushy Fork Creek in a Southwesterly direction to a point where the center line of said creek intersects with the East (E) section line of Section 12, T 19 N, R 17 W; Thence south approximately 1/2 mile to the Southeast (SE) corner of Section 12; thence west approximately 2 1/2 miles to the Northwest (NW) corner of Northeast Quarter (NE 1/4) of Section 15; thence south 2 miles to the Southeast (SE) corner of the Southwest Quarter (SW 1/4) of Section 22, T 19 N, R 17 W; thence west approximately 3 1/2 miles to the Southwest (SW) corner of Section 19; thence north approximately 4 miles to the Northwest (NW) corner of Section 6, T 19 N, R 17 W; thence west approximately 3 miles to the Southwest (SW) corner of Section 34, T 20 N, R 18 W, being the Boone-Marion County Line; thence west approximately 4 miles to the Southwest (SW) corner of Section 36, T 20 N, R 19 W; thence north 2 miles to the Northwest (NW) corner of Section 25; thence west approximately 7 miles to the Southwest (SW) corner of Section 23, T 20 N, R 20 W; thence north 1 mile to the Northwest (NW) corner of Section 23; thence east 1 mile to the Northeast (NE) corner of section 23; thence north approximately 4 miles to the Northeast (NE) corner of Section 35, T 21 N, R 20 W; thence west approximately 1/2 mile to a point where the North Section Line of Section 35 intersects with the center line of Bear Creek; thence meandering along the center line of Bear Creek in a generally northeasterly direction to a point where the

THIS SPACE FOR PSC USE ONLY

ARKANSAS PUBLIC SERVICE COMMISSION
APPROVED

AUG 31 '95 ORDER 2 95 - 102 - TF

ARKANSAS PUBLIC SERVICE COMMISSION

ARK. PUBLIC SERV. COMM.
IAN SANDERS
SECRETARY OF COMM.

Original Sheet No. 104

AUG 14 9 38 AM '95

Replacing _____ Sheet No. ____

Northern Arkansas Telephone Company, Inc.

FILED

Name of Company

Kind of Service: Telecommunications Class of Service: All

Part V. Map Schedule No.: 8

Title: LEAD HILL EXCHANGE

PSC File Mark Only

creek becomes an Arm of Bull Shoals Lake and continuing along the center line of the Bear Creek Arm of Bull Shoals Lake in a northeasterly direction to a point where the center line of the Bear Creek Arm intersects with the center line of Bull Shoals Lake and the Arkansas-Missouri State Line in Section 5, T 21 N, R 19 W, the point of beginning.....

THIS SPACE FOR PSC USE ONLY

ARKANSAS PUBLIC SERVICE COMMISSION
APPROVED

AUG 31 '95 ORDER 2 95-102-TF

Original Sheet No. 105

Northern Arkansas Telephone Co., Inc.

Kind of Service: Telecommunications Class of Service: All

Part V. Map Schedule No.: 9

Title: LEAD HILL MAP

ARKANSAS PUBLIC SERVICE COMMISSION
APPROVED

AUG 31 '95 ORDER 2 . 95 - 102 - TF

ANN. PUBL. SERV. COM.
JAN SANDERS
SECRETARY OF COMM.

AUG 25 9 29 AM '95

FILED

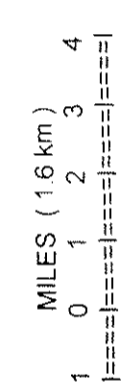
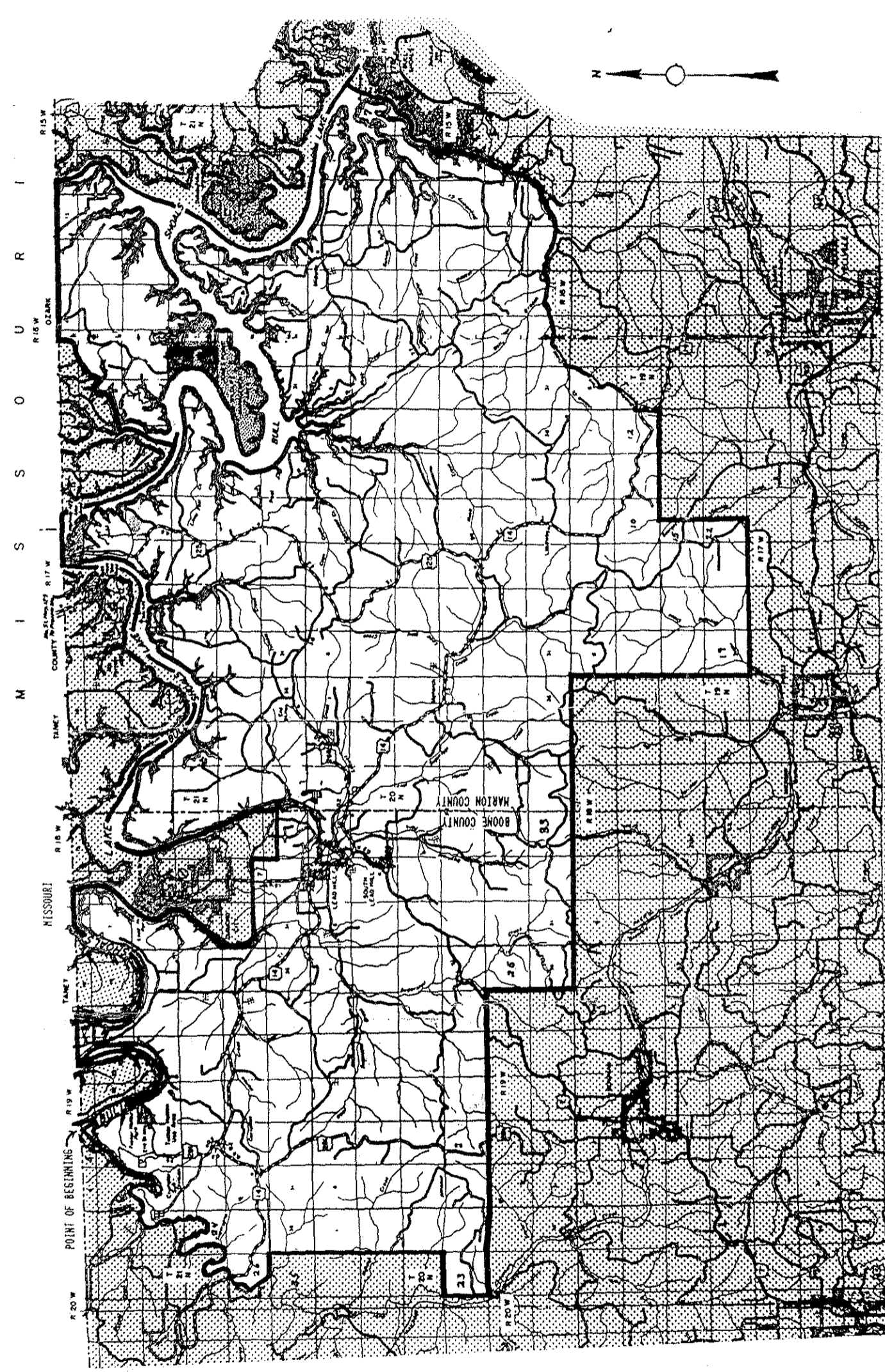

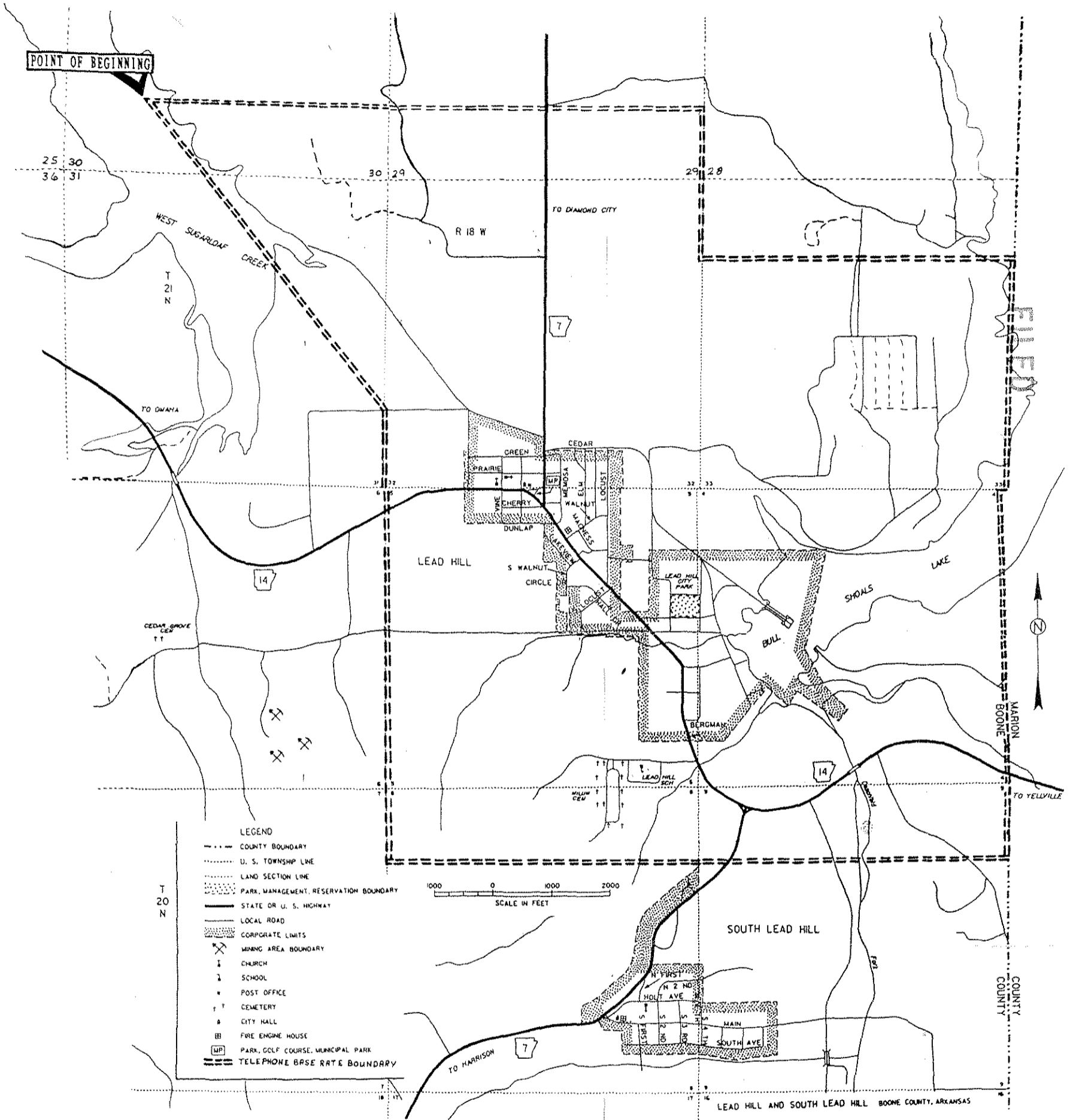

JAN 19 9 39 AM '96

JAN SANDERS
SECRETARY OF COM.

ARKANSAS PUBLIC SERVICE COMMISSION
APPROVED

FEB 6 '96 ORDER 3 95-102-1F

ARKANSAS PUBLIC SERVICE COMMISSION

ARK. PUBLIC. SERV. COMM.
 JAN SANDERS
 SECRETARY OF COMM.

Original Sheet No. 107

Replacing _____ Sheet No. _____

Northern Arkansas Telephone Company, Inc.

Name of Company

Kind of Service: Telecommunications Class of Service: All

Part V. Map Schedule No.: 11

Title: OMAHA EXCHANGE

AUG 14 9 38 AM '95

FILED

PSC File Mark Only

Beginning at a point, near the center line of Table Rock Lake, where the center line of Blair Branch intersects with the west section line of Section 11, T 21 N, R 22 W, also, the said west section line being the Boone/Carroll County line; thence meandering along the center of Blair Branch in a northeasterly direction to a point where the said center line intersects with the Arkansas/Missouri State line in the Northeast Quarter (NE 1/4) of Section 12, T 21 N, R 22 W; thence east approximately 14 miles along the State line to a point where the State Line intersects with the center line of the Bear Creek arm of Bull Shoals Lake, near the center line of the main channel of Bull Shoals Lake in Section 5, T 21 N, R 19 W; thence meandering in a generally southwesterly direction along the center line of the Bear Creek arm of Bull Shoals Lake and continuing along the center line of Bear Creek to a point where the said center line intersects with the north section line of Section 35, T 21 N, R 20 W; thence east approximately 1/2 mile to the Northeast (NE) corner of Section 35; thence south approximately 4 miles to the Southeast (SE) corner of Section 14, T 20 N, R 20 W; thence west approximately 1 mile to the Southwest (SW) corner of Section 14; thence south approximately 1 mile to the Southeast (SE) corner of Section 22; thence west approximately 1/2 mile to the Southwest (SW) corner of the Southeast Quarter (SE 1/4) of Section 22; thence north approximately 1/2 mile to the Northwest (NW) corner of the Southeast Quarter of Section 22; thence west approximately 1/2 mile to the Northwest (NW) corner of the Southwest Quarter (SW 1/4) of Section 22; thence south approximately 1/2 mile to

THIS SPACE FOR PSC USE ONLY

ARKANSAS PUBLIC SERVICE COMMISSION
 APPROVED

AUG 31 '95 ORDER 2 95 - 102 - TF

ARKANSAS PUBLIC SERVICE COMMISSION

ARK. PUBLIC. SERV. COMM.
 JAN SANDERS
 SECRETARY OF COMM.

Original Sheet No. 108

Replacing _____ Sheet No. _____

Northern Arkansas Telephone Company, Inc.

Name of Company

Kind of Service: Telecommunications Class of Service: All

Part V. Map Schedule No.: 11

Title: OMAHA EXCHANGE

AUG 14 9 38 AM '95

FILED

PSC File Mark Only

the Southwest (SW) corner of the Southwest Quarter (SW 1/4) OF Section 22; thence west approximately 1 1/2 miles to the Northeast (NE) corner of the Northwest Quarter (NW 1/4) of Section 29; thence south approximately 1 mile to the Southeast (SE) corner of the Southwest Quarter (SW 1/4) of Section 29; thence west approximately 1 1/2 mile to the Southwest (SW) corner of Section 30; thence south approximately 1 mile to the Southeast (SE) corner of Section 36; thence west approximately 3 miles to the Northeast (NE) corner of Section 4, T 19 N, R 21 W; thence south approximately 1/4 mile to the Southeast (SE) corner of the Northeast Quarter (NE 1/4) of the Northeast Quarter (NE 1/4) of Section 4; thence west approximately 1 mile to the Southwest (SW) corner of the Northwest Quarter (NW 1/4) of the Northwest Quarter (NW 1/4) of Section 4; thence north approximately 1/4 mile to the Northwest (NW) corner of Section 4; thence east approximately 1/8 mile to the Southwest (SW) corner of Section 33, T 20 N, R 21 W; thence north approximately 1 mile to the Northwest (NW) corner of Section 33; thence west approximately 2 miles to the Southwest (SW) corner of Section 30; thence north approximately 1 mile to the Northwest (NW) corner of Section 30; thence west approximately 1 mile to the Southwest (SW) corner of Section 24, T 20 N, R 22 W; thence north approximately 1 mile to the Northwest corner of Section 24; thence west approximately 1 mile to the southwest (SW) corner of Section 14, this being the Boone/Carroll County Line; thence north along said County Line approximately 4 1/4 mile to the Northwest (NW) corner of the Southwest

THIS SPACE FOR PSC USE ONLY

ARKANSAS PUBLIC SERVICE COMMISSION
 APPROVED

AUG 31 '95 ORDER 2 95 - 102 - TF

ARKANSAS PUBLIC SERVICE COMMISSION

ARK. PUBLIC. SERV. COMM.
 JAN SANDERS
 SECRETARY OF COMM.

Original Sheet No. 109

Replacing _____ Sheet No. _____

AUG 14 9 39 AM '95

Northern Arkansas Telephone Company, Inc.

Name of Company

Kind of Service: Telecommunications Class of Service: All

FILED

Part V. Map Schedule No.: 11

Title: OMAHA EXCHANGE

PSC File Mark Only

Quarter (SW 1/4) of the Southwest Quarter (SW 1/4) of Section 26, T 21 N, R 22 W; thence east approximately 1/4 mile to the Northeast (NE) corner of the Southwest Quarter (SW 1/4) of the Southwest Quarter (SW 1/4) of Section 26; thence north approximately 1/2 mile to the Southeast (SE) corner of the Northwest Quarter (NW 1/4) of the Northwest Quarter (NW 1/4) of Section 26; thence west approximately 1/4 mile to the Southwest corner of the Northwest Quarter (NW 1/4) of the Northwest Quarter (NW 1/4) of Section 26; thence north approximately 3/8 mile to a point where the west section line of Section 23 intersects with the center line of Long Creek near the Southwest (SW) corner of Section 23; thence meandering along the center line of Long Creek, first in a northwesterly then a northeasterly direction through Section 22 and Section 15, in Carroll County to a point where the said center line intersects with the west section line of Section 14, in the Southwest Quarter (SW 1/4) of Section 14; thence north along the Carroll/Boone county line approximately 1/2 mile to a point where the west line of Section 14 intersects with the center line of the Cricket Creek arm of Table Rock Lake in the Northwest Quarter of Section 14; thence meandering first in a westerly then in a northeasterly direction through section 15 and section 10 in Carroll County to a point where the center line of said lake intersects with the west line of Section 11; thence north to a point near the center line of Table Rock Lake where the center line of Blair Branch intersects with the west section line of Section 11, T 21 N, R 22 W, the point of beginning.

THIS SPACE FOR PSC USE ONLY

ARKANSAS PUBLIC SERVICE COMMISSION
 APPROVED

AUG 31 '95 ORDER 2 95 - 102 - TF

Northern Arkansas Telephone Co., Inc.

Kind of Service: Telecommunications Class of Service: All

Part V. Map Schedule No.: 12

Title: OMAHA MAP

ARKANSAS PUBLIC SERVICE COMMISSION
APPROVED

AUG 31 '95 ORDER 2 95-102-TF

M I S S O U R I

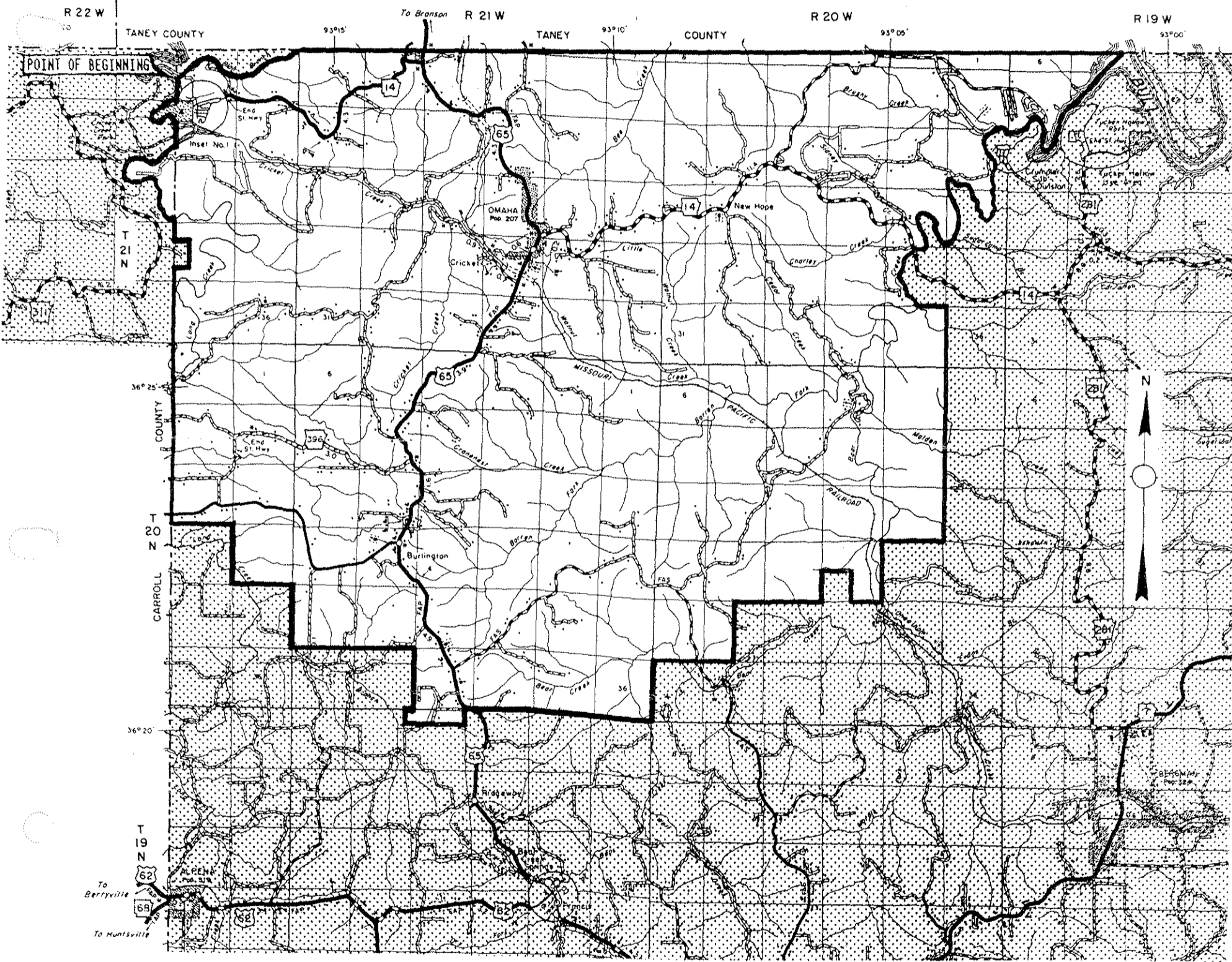

FILED

AUG 14 9 39 AM '95

JAN SANDERS
SECRETARY OF COMM.

1st Revised Sheet No. 111
 Replacing Original Sheet No. 111
 Northern Arkansas Telephone Co., Inc.
 Kind of Service: Telecommunications Class of Service: All
 Part V. Map Schedule No.: 13
 Title: OMAHA BRA MAP

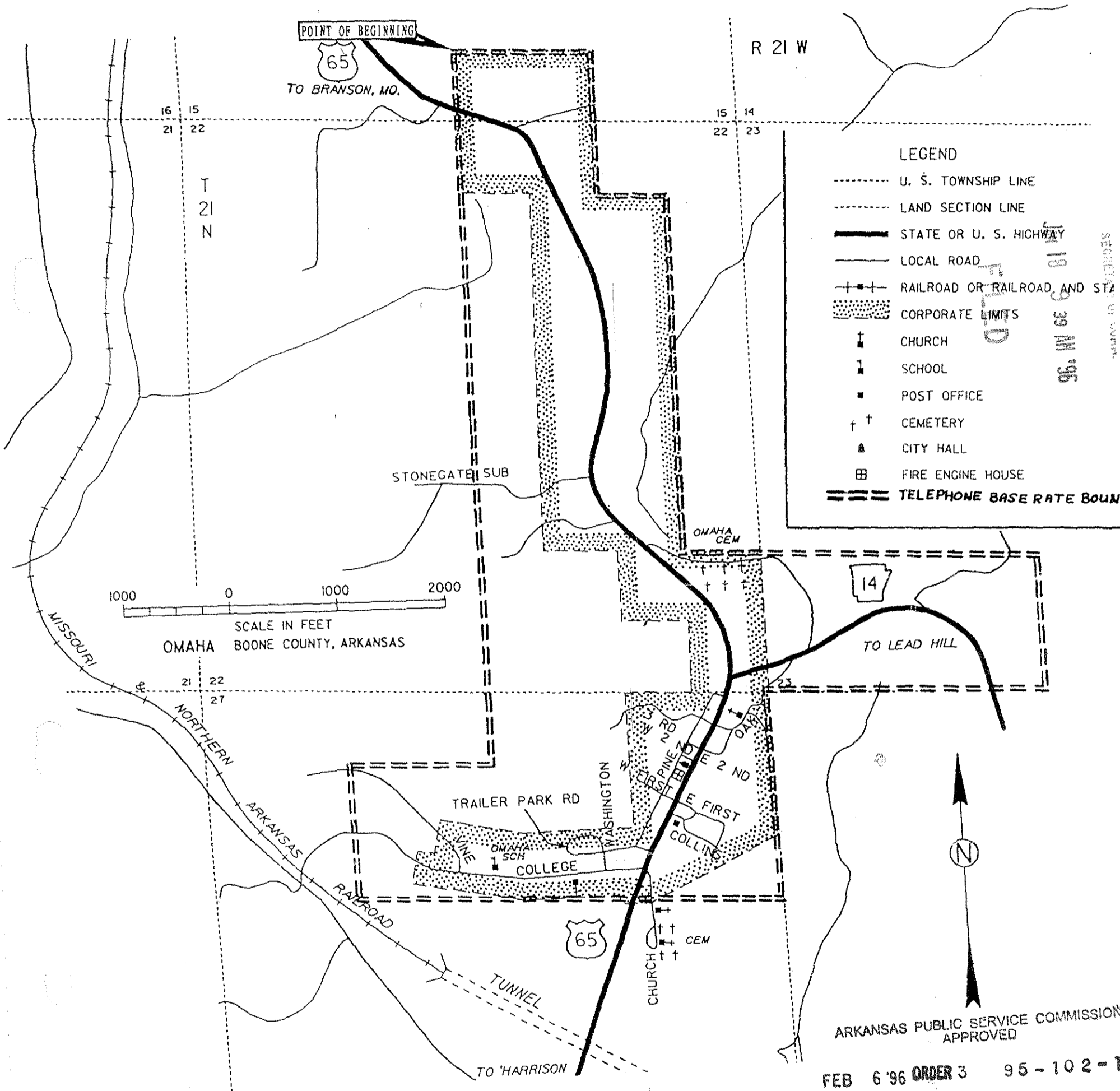

FILED
 FEB 19 9 39 AM '96
 SECRETARY OF COMPT.

ARKANSAS PUBLIC SERVICE COMMISSION
 APPROVED
 FEB 6 '96 ORDER 3 95-102-T

ARKANSAS PUBLIC SERVICE COMMISSION

ARK. PUBLIC SERV. COMM.
 JAN SANDERS
 SECRETARY OF COMM.

Original Sheet No. 112

Replacing _____ Sheet No. _____

NORTHERN ARKANSAS TELEPHONE COMPANY, INC.

Name of Company

Kind of Service: Telecommunications Class of Service: All

Part V. Map Schedule No.: 14
 PYATT EXCHANGE

Title:

AUG 14 9 39 AM '95

FILED

PSC File Mark Only

Beginning at a point where the center line of Shepherd Hollow intersects with the Northwest (NW) corner of Section 1, T 19 N, R 19 W; thence east approximately 4 miles to the Northeast (NE) corner of Section 4, T 19 N, R 18 W, which is the Boone-Marion County line; continuing east, in Marion county, approximately 3 miles to the Northeast (NE) corner of Section 1; thence south approximately 4 miles to the Southeast (SE) corner of Section 24; thence east approximately 3 1/2 miles to the Northeast (NE) corner of the Northwest Quarter (NW 1/4) of Section 27, T 19 N, R 17 W; thence south approximately 1 mile to the Southwest (SW) corner of the Southeast Quarter (SE 1/4) of Section 27; thence west approximately 1/2 mile to the Northwest (NW) corner of Section 34; thence south approximately 1 mile to the Southwest corner of Section 34; thence west approximately 1/4 mile to the Northeast (NE) corner of the Northwest Quarter (NW 1/4) of the Northeast Quarter (NE 1/4) of Section 4, T 18 N, R 17 W; thence south approximately 1 mile to the Southwest (SW) corner of the Southeast Quarter (SE 1/4) of the Southeast Quarter (SE 1/4) of Section 4; thence east approximately 1 1/4 miles to the Northeast (NE) corner of Section 10; thence south approximately 3 1/2 miles to the Southwest (SW) corner of the Northwest Quarter (NW 1/4) of Section 26; thence east approximately 1/2 mile to the Southeast (SE) corner of the Northwest Quarter (NW 1/4) of Section 26; thence south approximately 1 mile to the Southeast (SE) corner of the Northwest Quarter (NW 1/4) of Section 35; thence east approximately 1/2 mile to the Southeast (SE) corner of the Northeast Quarter (NE 1/4) of Section 35; thence

THIS SPACE FOR PSC USE ONLY

ARKANSAS PUBLIC SERVICE COMMISSION
 APPROVED

AUG 31 '95 ORDER 2 95 - 102 - TF

ARKANSAS PUBLIC SERVICE COMMISSION

ARK. PUBLIC. SERV. COMM.
 JAM. SANBERS
 SECRETARY OF COMM.

Original _____ Sheet No. 113

Replacing _____ Sheet No. _____

NORTHERN ARKANSAS TELEPHONE COMPANY, INC

Name of Company _____

Kind of Service: Telecommunications Class of Service: All

Part V. Map Schedule No.: 14
 PYATT EXCHANGE

Title: _____

AUG 14 9 39 AM '95

FILED

PSC File Mark Only

south approximately 1/2 mile to the Southeast (SE) corner of Section 35; thence east approximately 1 mile to Southeast (SE) corner of Section 36; thence south approximately 5 miles to the Southeast (SE) corner of Section 25, T 17 N, R 17 W; thence west approximately 2 miles to the Southeast corner of Section 27; Thence south approximately 1 mile to the Southeast (SE) corner of Section 34, being the Marion-Searcy County line; thence west approximately 3 1/4 miles to the Southwest (SW) corner of the Southeast Quarter (SE 1/4) of the Southeast Quarter (SE 1/4) of Section 31; thence north approximately 2 miles to the Northwest (NW) corner of the Northeast Quarter (NE 1/4) of the Northeast Quarter (NE 1/4) of Section 30; thence west approximately 3/4 mile to the Northwest corner of Section 30, again being the Marion-Searcy County line; thence north approximately 1 mile to the southeast (SE) corner of Section 13, T 17 N, R 18 W; thence west approximately 3 miles to the Southwest (SW) corner of Section 15, being the point where Marion, Searcy and Boone counties meet; thence north approximately 4 1/2 miles, along the Marion-Boone county line, to the Northwest (NW) corner of the Southwest Quarter (SW 1/4) of Section 27, T 18 N, R 18 W; thence east approximately 1/2 mile to the Northeast (NE) corner of the Southwest Quarter (SW 1/4) of Section 27; thence north approximately 1 mile to the Northeast (NE) corner of the Southwest Quarter (SW 1/4) of Section 22; thence west approximately 1/2 mile to the Northwest (NW) corner of the Southwest Quarter (SW 1/4) of Section 22; thence north approximately 1/2 mile, along the Marion-Boone county line, to the Southeast (SE) corner of

THIS SPACE FOR PSC USE ONLY

ARKANSAS PUBLIC SERVICE COMMISSION
 APPROVED

AUG 31 '95 ORDER 2 95-102-TF

ARKANSAS PUBLIC SERVICE COMMISSION

ARK. PUBLIC SERV. COMM.
 JAN SANDERS
 SECRETARY OF COMM.

Original

Sheet No. 114

Replacing _____ Sheet No. _____

NORTHERN ARKANSAS TELEPHONE COMPANY, INC

AUG 14 9 39 AM '95

FILED

Name of Company

Telecommunications

All

Kind of Service: _____ Class of Service: _____

Part V. Map Schedule No.: 14

PYATT EXCHANGE

Title:

PSC File Mark Only

Section 16; thence west approximately 1 mile to the Southwest (SW) corner of Section 16; thence south approximately 1 mile to the Southeast (SE) corner of Section 20; thence west approximately 1 mile to the Southwest corner of Section 20; thence north approximately 1 mile to the Southeast (SE) corner of Section 18; thence west approximately 1 mile to the Southwest (SW) corner of Section 18; thence north approximately 3 miles to the Southwest (SW) corner of Section 31, T 19 N, R 18 W; thence west approximately 1/2 mile to the Southwest (SW) corner of the Southeast Quarter (SE 1/4) of Section 36, T 19 N, R 19 W; thence north approximately 1 mile to the Northeast (NE) corner of the Northwest Quarter (NW 1/4) of Section 36; thence west approximately 1/2 mile to the Northwest (NW) corner of Section 36; thence north approximately 1 1/4 mile to the Southwest (SW) corner of the Northwest Quarter (NW 1/4) of the Southwest Quarter (SW 1/4) of Section 24, T 19 N, R 19 W; thence east approximately 1/4 mile to the Southeast (SE) corner of the Northwest Quarter (NW 1/4) of the Southwest Quarter (SW 1/4) of Section 24; thence north approximately 1/2 mile to the Northeast (NE) corner of the Southwest Quarter (SW 1/4) of the Northwest Quarter (NW 1/4) of Section 24; thence west approximately 1/4 mile to the Northwest (NW) corner of the Southwest Quarter (SW 1/4) of the Northwest Quarter (NW 1/4) of Section 24; thence north approximately 2 1/8 miles to a point where the Missouri-Pacific Railroad right-of-way intersects with the west line of Section 1, T 19 N, R 19 W; thence meandering in a northeasterly, then easterly direction along the center line of said

THIS SPACE FOR PSC USE ONLY

ARKANSAS PUBLIC SERVICE COMMISSION
 APPROVED

AUG 31 '95 ORDER 244 95-102-TF

ARKANSAS PUBLIC SERVICE COMMISSION

ARK. PUBLIC SERV. COMM.
JAN SANDERS
SECRETARY OF COMM.

Original

Sheet No. 115

Replacing _____ Sheet No. _____

NORTHERN ARKANSAS TELEPHONE COMPANY, INC.

Name of Company

Telecommunications All

Kind of Service: _____ Class of Service: _____

Part V. Map Schedule No.: 14

PYATT EXCHANGE

Title:

PSC File Mark Only

AUG 14 9 39 AM '95

FILED

Missouri-Pacific Railroad right-of-way for approximately 1/2 mile to a point where the said center line of the railroad passes over the center line of the drainage known as Shepherd Hollow at approximately the east-west dividing line of Section 1; thence meandering in a northwesterly direction along the center line of said Shepherd Hollow for approximately 3/4 mile to a point where said center line intersects with the Northwest (NW) corner of Section 1, T 19 N, R 19 W, the point of beginning.

THIS SPACE FOR PSC USE ONLY

ARKANSAS PUBLIC SERVICE COMMISSION
APPROVED

AUG 31 '95 ORDER 2 95 - 102 - TF

Northern Arkansas Telephone Co., Inc.

Kind of Service: Telecommunications Class of Service: All

Part V. Map Schedule No.: 15

Title: PYATT MAP

ARKANSAS PUBLIC SERVICE COMMISSION
APPROVED

AUG 31 '95 ORDER 2-4 95-102-TF

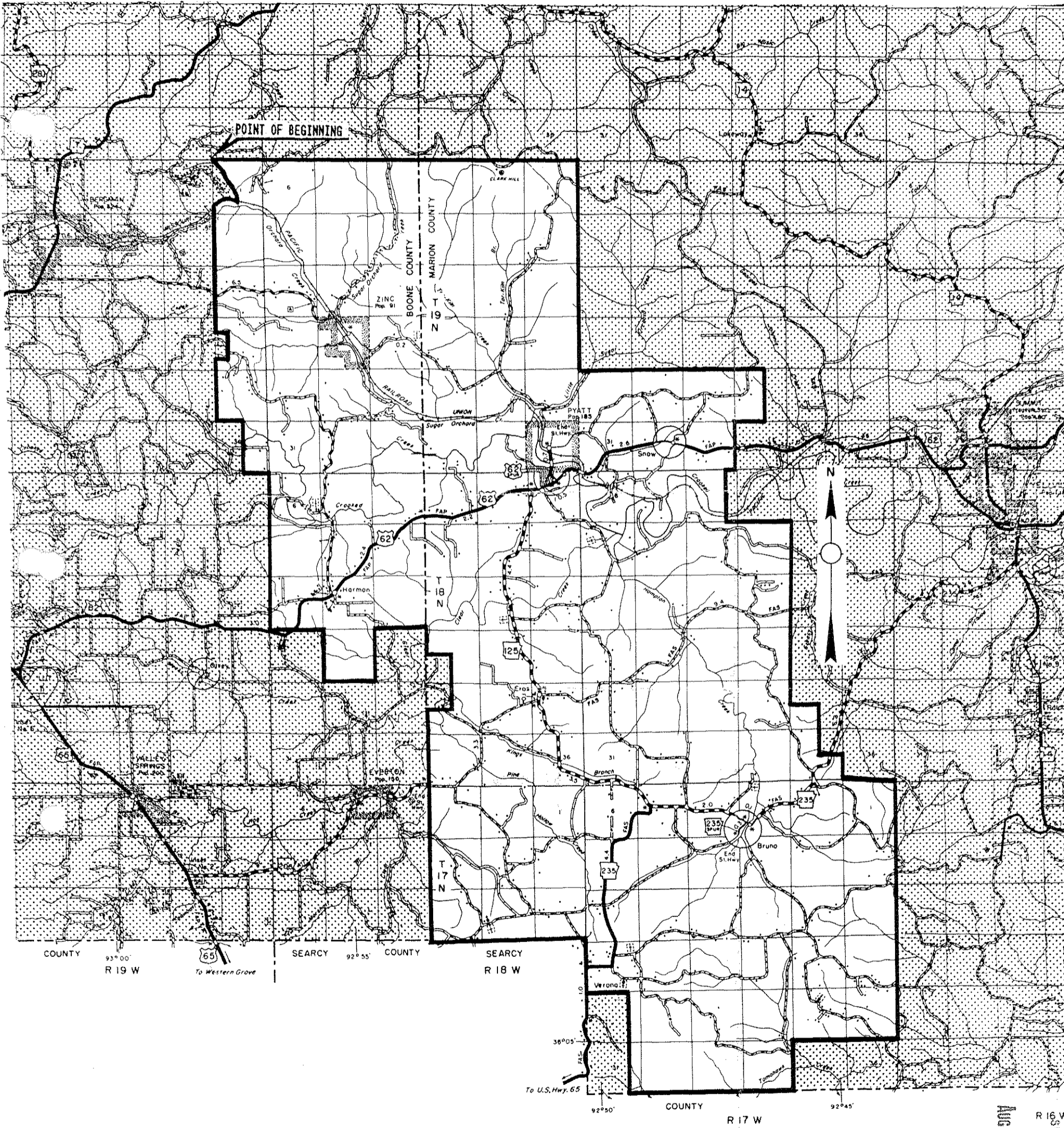

FILED

AUG 14 9 39 AM '95

SECRETARY OF COMM.

1st Revised Sheet No. 117

Replacing Original Sheet No. 117

Northern Arkansas Telephone Co., Inc.

Kind of Service Telecommunications Class of Service: All

Part V. Map Schedule No.: 16

Title: PYATT BRA MAP

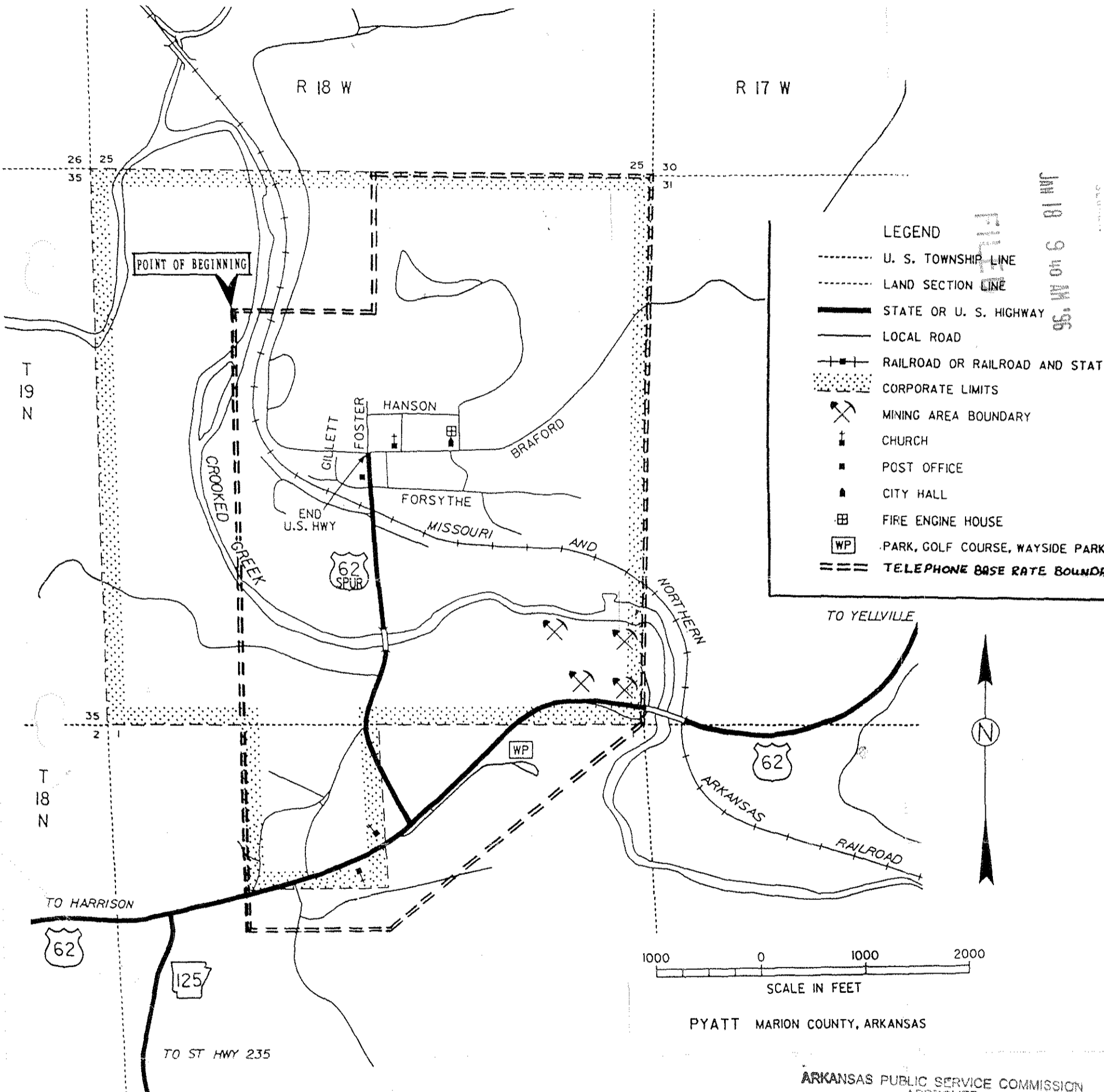

JUN 10 9 10 AM '96

- LEGEND**
- U. S. TOWNSHIP LINE
 - LAND SECTION LINE
 - STATE OR U. S. HIGHWAY
 - LOCAL ROAD
 - RAILROAD OR RAILROAD AND STATE HIGHWAY
 - ... CORPORATE LIMITS
 - ⌵ MINING AREA BOUNDARY
 - † CHURCH
 - POST OFFICE
 - ▲ CITY HALL
 - ▣ FIRE ENGINE HOUSE
 - WP PARK, GOLF COURSE, WAYSIDE PARK
 - === TELEPHONE BASE RATE BOUNDARY

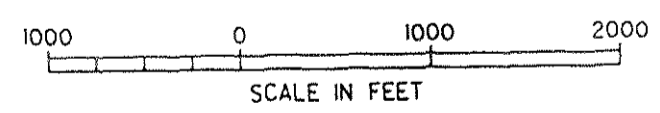

PYATT MARION COUNTY, ARKANSAS

ARKANSAS PUBLIC SERVICE COMMISSION APPROVED

EEB 6 '96 ORDER 3 95-102-TF

ARKANSAS PUBLIC SERVICE COMMISSION

ARK. PUBLIC SERV. COMM.
DIVISION OF P.S.
SECRETARY OF COMM.

Original Sheet No. 118

Replacing _____ Sheet No. ____

Northern Arkansas Telephone Co., Inc.
Name of Company

Kind of Service: Telecommunications Class of Service: All

Part V. Map Schedule No.: 17

Title: PYATT BRA BOUNDARIES

JAN 13 9 39 AM '96

FILED

PSC File Mark Only

Beginning at the Northwest (NW) corner of the Southeast Quarter (SE 1/4) of the Northwest Quarter (NW 1/4) of Section 36, T 19 N, R 18 W; thence East (approximately 1/4 mile) to the Northeast (NE) corner of the Southeast Quarter (SE 1/4) of the Northwest Quarter (NW 1/4) of Section 36; thence North (approximately 1/4 mile) to the Northeast (NE) corner of the Northwest Quarter (NW 1/4) of Section 36, this being the East/ West center of the North Section line of Section 36; thence East along the Section line (approximately 1/2 mile) to the Northeast (NE) corner of Section 36; thence South (approximately 1 mile) to the Southeast (SE) corner of Section 36; thence Southwest (approximately .6 of a mile) to the Southeast (SE) corner of the Northeast Quarter (NE 1/4) of the Southeast Quarter (SE 1/4) of the Northwest Quarter (NW 1/4) of Section 1, T 18 N, R 18 W; thence West (approximately 1/4 mile) to the Southwest (SW) corner of the Northwest Quarter (NW 1/4) of the Southeast Quarter (SE 1/4) of the Northwest Quarter (NW 1/4) of Section 1; thence North (approximately 1.12 miles) to the Northwest (NW) corner of the Southeast Quarter (SE 1/4) of the Northwest Quarter (NW 1/4) of Section 36, T 19 N, R 18 W, the point of beginning:

THIS SPACE FOR PSC USE ONLY

ARKANSAS PUBLIC SERVICE COMMISSION
APPROVED

FEB 6 '96 ORDER 3 95 - 102 - TF

ARKANSAS PUBLIC SERVICE COMMISSION

AR. PUBLIC SERV. COM.
 1966
 SECRET. OFF. COMM.

Original Sheet No. 119

Replacing _____ Sheet No. ____

Northern Arkansas Telephone Co., Inc.

Name of Company

Kind of Service: Telecommunications Class of Service: All

Part V. Map Schedule No.: 18

Title: FLIPPIN BRA BOUNDARIES

PSC File Mark Only

JAN 13 9 39 AM '66

FILED

Beginning at a point where the West line of the Northeast Quarter (NE 1/4) of the Northeast Quarter (NE 1/4) of Section 19, T 19 N, R 15 W; intersects with the center line of State Highway 202 (Fallen Ash Road); thence East along the center line of Highway 202 to a point where said center line intersects with the center line of State Highway 178; thence North along the center line of Highway 178 to a point where said center line intersects with the center line of County Road 859 (Quarry Mountain Road) in the Southeast Quarter (SE 1/4) of the Northeast Quarter (NE 1/4) of the Southeast Quarter (SE 1/4) of Section 18; thence East (approximately 1/2 mile) to the center line of State Highway 980 (Airport Road) in the Southwest Quarter (SW 1/4) of the Northeast Quarter (NE 1/4) of the Southwest Quarter (SW 1/4) of Section 17; Following said center line in a Northeasterly direction to a point where said center line intersects with the North line of the Southeast Quarter (SE 1/4) of Section 17; thence East to the Northeast (NE) corner of the Northwest Quarter (NW 1/4) of the Southeast Quarter (SE 1/4) of Section 17; thence South (approximately 1/2 mile) to the Southeast (SE) corner of the Southwest Quarter (SW 1/4) of the Southeast Quarter (SE 1/4) of Section 17; thence East (approximately 1/2 mile) to the Northeast (NE) corner of the Northwest Quarter (NW 1/4) of the Northwest Quarter (NW 1/4) of Section 21; thence South (approximately 1 & 1/4 miles) to the Southeast (SE) corner of the Northwest Quarter (NW 1/4) of the Northwest Quarter (NW 1/4) of Section 28; thence Northwest to the Northwest (NW) corner of Section 28; thence

THIS SPACE FOR PSC USE ONLY

ARKANSAS PUBLIC SERVICE COMMISSION
 APPROVED

FEB 6 '96 ORDER 3 95-102-TF

ARKANSAS PUBLIC SERVICE COMMISSION

ARK. PUBLIC SERVICE COM.
STATE OF ARK.
COMMISSION OF COM.
JAN 13 9 39 AM '96

Original Sheet No. 120

Replacing Sheet No.

Northern Arkansas Telephone Co., Inc.
Name of Company

Kind of Service: Telecommunications Class of Service: All

Part V. Map Schedule No.: 18

Title: FLIPPIN BRA BOUNDARIES

PSC File Mark Only

West (approximately 1 & 1/4 miles) to the Southwest (SW) corner of the Southeast Quarter (SE 1/4) of the Southeast Quarter (SE 1/4) of Section 19; thence North (approximately 9.8 tenths of a mile) to a point where the West line of the Northeast Quarter (NE 1/4) of the Northeast Quarter (NE 1/4) of Section 19, T 19 N, R 15 W, intersects with the center line of State Highway 202 (Fallen Ash Road), the point of beginning:

THIS SPACE FOR PSC USE ONLY

ARKANSAS PUBLIC SERVICE COMMISSION
APPROVED

FEB 6 '96 ORDER 3 95-102-TF

ARKANSAS PUBLIC SERVICE COMMISSION

ARKANSAS PUBLIC SERVICE COMMISSION
REGULATORY DIVISION
SECRETARY OF COM.

Original _____ Sheet No. 121

Replacing _____ Sheet No. _____

Northern Arkansas Telephone Co., Inc.
Name of Company

Kind of Service: Telecommunications Class of Service: All

Part V. Map Schedule No.: 19

Title: LEAD HILL BRA BOUNDARIES

JAN 10 9 39 AM

FILED

PSC File Mark Only

Beginning at the Northwest (NW) corner of the Southeast Quarter (SE 1/4) of the Southwest Quarter (SW 1/4) of Section 30, T 21 N, R 18 W; thence East (approximately 1 & 3/4 miles) to the Northeast (NE) corner of the Southeast Quarter (SE 1/4) of the Southeast Quarter (SE 1/4) of Section 29; thence South (approximately 1/2 mile) to the Northeast (NE) corner of the Southeast Quarter (SE 1/4) of the Northeast Quarter (NE 1/4) of Section 32; thence East (approximately 1 mile) to the Northeast (NE) corner of the Southeast Quarter (SE 1/4) of the Northeast Quarter (NE 1/4) of Section 33; thence South (approximately 2 miles) to the Southeast (SE) corner of the Northeast Quarter (NE 1/4) of the Northeast Quarter (NE 1/4) of Section 9, T 20 N, R 18 W; thence West (approximately 2 miles) to the Southwest (SW) corner of the Northwest Quarter (NW 1/4) of the Northwest Quarter (NW 1/4) of Section 8; thence North (approximately 1 & 1/2 miles) to the Northwest (NW) corner of the Southwest Quarter (SW 1/4) of the Southwest Quarter (SW 1/4) of Section 32, T 21 N, R 18 W; thence in a Northwesterly direction (approximately 1 & 1/4 miles) to the Northwest (NW) corner of the Southeast Quarter (SE 1/4) of the Southwest Quarter (SW 1/4) of Section 30, T 21 N, R 18 W, the point of beginning;

THIS SPACE FOR PSC USE ONLY

ARKANSAS PUBLIC SERVICE COMMISSION
APPROVED

FEB 6 '96 ORDER 3 95 - 102 - TF

ARKANSAS PUBLIC SERVICE COMMISSION

ARK. PUBLIC SERV. COM.
MEMPHIS
SECRETARY OF COM.

Original _____ Sheet No. 122

Replacing _____ Sheet No. _____

Northern Arkansas Telephone Co., Inc.

Name of Company

Kind of Service: Telecommunications Class of Service: All

Part V. Map Schedule No.: 29

Title: OMAHA BRA BOUNDARIES

PSC File Mark Only

JAN 10 9 39 AM '96

FILED

Beginning at the Northwest (NW) corner of the Southwest Quarter (SW 1/4) of the Southwest Quarter (SW 1/4) of the Southeast Quarter (SE 1/4) of Section 15, T 21 N, R 21 W; thence East (approximately 1/4 mile) to the Northeast (NE) corner of the Southeast Quarter (SE 1/4) of the Southwest Quarter (SW 1/4) of the Southeast Quarter (SE 1/4) of Section 15; thence South (approximately 1/4 mile) to the Northeast (NE) corner of the Southeast Quarter (SE 1/4) of the Northwest Quarter (NW 1/4) of the Northeast Quarter (NE 1/4) of Section 22; thence East (approximately 1/8 mile) to the Northeast (NE) corner of the Southwest Quarter (SW 1/4) of the Northeast Quarter (NE 1/4) of the Northeast Quarter (NE 1/4) of Section 22; thence South (approximately 5/8 mile) to the Northeast (NE) corner of the Northwest Quarter (NW 1/4) of the Southeast Quarter (SE 1/4) of the Southeast Quarter (SE 1/4) of Section 22; thence east (approximately 5/8 mile) to the Northeast (NE) corner of the Southeast Quarter (SE 1/4) of the Southwest Quarter (SW 1/4) of Section 23; thence South (approximately 1/4 mile) to the Southeast (SE) corner of the Southwest Quarter (SW 1/4) of Section 23; thence west (approximately 1/2 mile) to the Northeast (NE) corner of Section 27; thence South (approximately 3/8 mile) to the Southeast (SE) corner of the Northeast Quarter (NE 1/4) of the Southeast Quarter (SE 1/4) of the Northeast Quarter (NE 1/4) of Section 27; thence West (approximately 3/4 mile) to the Southwest (SW) corner of the Northwest Quarter (NW 1/4) of the Southeast Quarter (SE 1/4) of the Northwest Quarter (NW 1/4) of Section 27; thence North (approximately 1/4 mile) to the Northwest (NW) corner of the Southwest Quarter (SW 1/4) of the Northeast Quarter (NE 1/4) of the Northwest Quarter (NW 1/4) of Section 27; thence East (approximately 1/4 mile) to the Northeast (NE) corner of the Southeast Quarter (SE 1/4) of the Northeast Quarter (NE 1/4) of the Northwest Quarter (NW 1/4) of Section 27; thence North (approximately 1 & 1/4 miles) to the Northwest (NW) corner of the Southwest Quarter (SW 1/4) of the Southwest Quarter (SW 1/4) of the Southeast Quarter (SE 1/4) of Section 15, T 21 N, R 21 W, the point of beginning:

THIS SPACE FOR PSC USE ONLY

ARKANSAS PUBLIC SERVICE COMMISSION
APPROVED

FEB 6 '96 ORDER 3 95 - 102 - TF